

DEPARTMENT OF THE ARMY TECHNICAL MANUAL

ORGANIZATIONAL, DIRECT AND GENERAL SUPPORT,
AND DEPOT MAINTENANCE REPAIR PARTS
AND SPECIAL TOOLS LIST

PRINTING PRESS; PROOF: OFFSET: FLOOR MOUNTING;
ELECTRIC-MOTOR DRIVEN;
AND HAND DRIVEN: AC, 208V, 3 PHASE,
50-60 CYCLE; HAND INKING: 36 IN. LONG:
30 IN. WIDE SHEET: 36 IN. LONG:
30 IN. WIDE PRINTING SURFACE;
37 1/4 IN. LONG, 33 IN.

WIDE INSIDE DIAMETER OF BED: MIL SPEC P-3500
(RUTHERFORD MACHINERY MODEL 2)
FSN 3610-242-3424



HEADQUARTERS, DEPARTMENT OF THE ARMY

APRIL 1967

TECHNICAL MANUAL }
No. 5-3610-200-25P

HEADQUARTERS
DEPARTMENT OF THE ARMY
WASHINGTON, D. C., 3 April 1967

**Organizational, Direct and General Support, and Depot
Maintenance Repair Parts and Special Tools List**

**PRINTING PRESS; PROOF: OFFSET: FLOOR MOUNTING;
ELECTRIC-MOTOR DRIVEN; AND HAND DRIVEN:
AC, 208V, 3 PHASE, 50-60 CYCLE; HAND INKING:
36 IN. LONG: 30 IN WIDE SHEET: 36 IN. LONG:
30 IN. WIDE PRINTING SURFACE; 37-1/4 IN. LONG,
33 IN. WIDE INSIDE DIAMETER OF BED:
MIL SPEC P-3500 (RUTHERFORD MACHINERY MODEL 2)
FSN 3610-242-3424**

	Paragraph	Page
SECTION 1.	INTRODUCTION	
	Scope	1 iii
	General	2 iii
	Explanations of columns	3 iii
	Special information	4 v
	How to locate repair parts	5 v
	Abbreviations	6 v
	Federal supply codes -	7 v
	Reporting of equipment publication improvements	8 v
2.	PRESCRIBED LOAD ALLOWANCE LIST	vi
SECTION 3.	REPAIR PARTS LIST, ORGANIZATIONAL LEVEL	
Group 18.	Body, Cab, Hood, Hull	
	1808 Stowage racks, boxes, straps	1
22.	Body, Chassis or Hull, and Accessory Items	
	2210 Data plates and instruction holders.....	1
40.	Electric Motors	
	4000 Motor assembly.....	1
	4007 Drive components	1
65.	Reproduction Equipment Components	
	6503 Offset main press assembly	1
95.	General Use Standardized Parts	
	9501 Bulk material	3
SECTION 4.	SPECIAL TOOLS, TEST AND SUPPORT EQUIPMENT, ORGANIZATIONAL LEVEL	
Group 26.	Tools and Test Equipment	
	2604 Special tools	4
SECTION 5.	REPAIR PARTS LIST, DS, GS, AND DEPOT LEVEL	
Group 18.	Body, Cab, Hood, Hull	
	1808 Stowage racks, boxes, straps	5

*This manual supersedes TM 5-3610-200-25P, 29 January 1962.

	Page
Group 22. Body, Chassis or Hull, and Accessory Items	
2210 Data plates and instruction holders	5
40. Electric Motors	
4000 Motor assembly	5
4007 Drive components	6
4010 Master or auxiliary control assembly-	6
4011 Circuit breakers, cutouts, fuse and fuse holders	6
4018 Terminal blocks, junction boxes	7
65. Reproduction Equipment Components	
6503 Offset main press assembly	7
95. General Use Standardized Parts	
9501 Bulk material	12
SECTION 6. SPECIAL TOOLS, TEST AND SUPPORT EQUIPMENT, DS, GS, AND DEPOT LEVEL	
Group 26. Tools and Test Equipment	
2604 Special tools.....	13
SECTION 7. FEDERAL STOCK NUMBER AND PART NUMBER INDEX.....	27

SECTION 1

INTRODUCTION

1. Scope

This manual contains a list of repair parts, special tools, and equipment required for the performance of organizational, direct support, general support, and depot maintenance of the printing press.

2. General

This repair parts and special tools list is divided into five principal sections and a Federal stock number index.

a. Section 2, Prescribed Load Allowance List (PLA), is a consolidated listing of repair parts quantitatively allocated for initial stockage at the organizational level. This is a mandatory minimum stockage allowance.

b. Section 3 Repair Parts List, is a list of repair parts authorized for the performance of maintenance at organizational level.

c. Section 4, Special Tools, Test and Support Equipment List, is a list of special tools, test and support equipment authorized for the performance of maintenance at organizational level.

d. Section 5, Repair Parts List, is a list of repair parts authorized for the performance of maintenance at the direct support, general support, and depot level.

e. Section 6, Special Tools, Test and Support Equipment List, is a list of special tools, test and support equipment authorized for the performance of maintenance at direct support, general support, and depot level.

f. Section 7, Federal Stock Number and Manufacturer's Part Number Index, is an index of Federal stock numbers and manufacturer's part numbers to page and manufacturer's codes.

g. Allowances are based on 3,000 hours operation per year.

3. Explanation of Columns

The following provides an explanation of columns in the tabular list.

a. Source, Maintenance, and Recoverability Codes.

- (1) Source Code indicates the selection status and source for the listed item. Source codes used are:

Code	Explanation
P	Applied to repair parts which are stocked in or supplied from DSA/GSA or Army supply system, and authorized for use at indicated maintenance categories.
M	Applied to repair parts which are not procured or stocked but are to be manufactured at indicated maintenance categories.
X1	Applied to repair parts which are not procured or stocked, the requirement for which will be supplied by use of the next higher assembly or components.
X2	Applied to repair parts which are not stocked. The indicated maintenance category requiring such repair parts will attempt to obtain them through cannibalization; if not obtainable through cannibalization, such repair parts will be requisitioned with supporting justification through normal supply channels.

- (2) Maintenance Code indicates the lowest category of maintenance authorized to install the listed item. The maintenance level codes are:

Code	Explanation
O	Organizational maintenance
F	Direct support maintenance
H	General support maintenance

- (3) Recoverability Code indicates whether unserviceable items should be returned for recovery or salvage. Items not coded are expendable. Recoverability code is:

Code	Explanation
R	Applied to repair parts and assemblies which are economically repairable at DSU and GSU activities and normally are furnished by supply on an exchange basis.

b. Federal Stock Number, indicates the Federal stock number for the item.

c. Description indicates the Federal item name and a brief description of the item. A five-digit manufacturer's or other service code, and part number is included in parentheses for reference. Repair parts quantities included in the kits, sets, and assemblies are shown in front of the repair part name.

d. Unit of Issue indicates the unit used as a basis of issue, e.g., ea, pr, ft, yd, etc.

e. Quantity Incorporated in Unit Pack indicates the actual quantity contained in the unit pack.

f. Quantity Incorporated in Unit indicates the quantity of repair parts in an assembly.

g. Fifteen-Day Organizational Maintenance Allowance.

- (1) The allowance columns are divided into four subcolumns. Indicated in each subcolumn opposite the first appearance of each item is the total quantity of items authorized for the number of equipments supported. Subsequent appearances of the same item will have no entry in the allowance columns, but have a reference in the description column to the first appearance of the item. Items authorized for use as required but not for initial stockage are identified with an asterisk in the allowance column.

- (2) The quantitative allowances for organizational level of maintenance represents one initial prescribed load for a 15-day period, for the number of equipments supported. Units and organizations authorized additional prescribed loads will multiply the number

of prescribed loads authorized by the quantity of repair parts reflected in the appropriate density column to obtain the total quantity of repair parts authorized.

- (3) Subsequent changes to allowances will be limited as follows: No change in the range of items is authorized. If additional items are considered necessary, recommendation should be forwarded to Mobility Equipment Command for exception or revision to the allowance list. The range of items authorized will be made by this Command based upon engineering experience, demand data, or TAERS information.

h. Thirty-Day DS/GS Maintenance Allowance.

- (1) The allowance columns are divided into three subcolumns. Indicated in each subcolumn, opposite the first appearance of each item, is the total quantity of items authorized for a number of equipments supported. Subsequent appearances of the same item will have no entry in the allowance column, but have reference in the description column, to the first appearance of the item. Items authorized for use as required but not for initial stockage are identified with an asterisk in the allowance column.

- (2) The quantitative allowances for DS/GS levels of maintenance will represent initial stockage for a 30-day period for the number of equipments supported.

i. One-Year Allowances Per 100 Equipments/Contingency Planning Purposes, indicates opposite the first appearance of each item the total quantity required for distribution and contingency planning purposes. The range of items indicates total quantities of all authorized items required to provide for adequate support of 100 equipments for one year.

j. Depot Maintenance Allowance Per 100 Equipments indicates opposite the first appearance of each item, the total quantity authorized

for depot maintenance of 100 equipments. Subsequent appearances of the same item will have no entry in this column, but have a reference in the description column, to the first appearance of the item. Items authorized for use but not for initial stockage are identified with an asterisk in the allowance column.

k. Illustration.

- (1) Figure Number indicates the figure number of the illustration by which the item is shown.
- (2) Item or Symbol Number indicates the callout number used to reference the item in the illustration.

4. Special Information

The following publications pertain to printing press and its components.

TM 5-6030	Press, Proving, Lithographic Offset, Motor Driven
LO 5-6030	Lubrication Order

5. How to Locate Repair Parts

a. When Federal stock number is unknown.

- (1) *First.* Using the index of contents, determine the functional group or subgroup, i.e., engine, engine assembly, transmission, transmission assembly, within which the repair part belongs. This is necessary because separate illustrations are prepared for functional groups or subgroups, and listings are divided into functional groups.
- (2) *Second.* Find the repair part illustration in the back of the publication covering the functional group or subgroup to which the repair part belongs.
- (3) *Third.* Identify the repair part on the illustration figure and item number of the repair part.
- (4) *Fourth.* Using the repair parts listing, find the functional group or subgroup of the repair part and the illustration figure and item number as noted on the illustration.

b. When Federal Stock Number or manufacturer's part number is known.

- (1) First. Use the index to locate the Federal stock number or manufacturer's part number. This index is arranged in alphameric sequence cross-referenced to page number and manufacturer's code.
- (2) Second. Refer to the appropriate page in the parts listing. Locate the functional group or subgroup of the repair part and the illustration figure and item number as indicated in the last two columns of the parts listing.

6. Abbreviations

AWG	American Wire Gage
deg.....	degree (s)
dia	diameter
ea	each
ft	foot (feet)
hp	horsepower
in.....	inch (es)
lg	long (length)
lh	left hand
mtg	mounting (s)
No.	number
ph	phase
rh	right hand
rpm	revolutions per minute
thd	thread
w/	with

7. Federal Supply Codes

Codes	Manufacturer
08288.....	Military Supply Standards
15605.....	Cutler-Hammer, Inc.
24446.....	General Electric Co.
24981.....	Gits Bros. Mfg. Co.
38740	Master Electric Co., The
41311	Monitor Controller Co.
52,565	Rutherford Machinery Co.
79470.....	Weatherhead Co., The
81336.....	Corps of Engineers

8. Reporting of Equipment Publication Improvements

DA Form 2028 (Recommended Changes to DA publications) will be used for reporting discrepancies and recommendations for improving this equipment publication. The form will be completed by the individual using the manual and forwarded direct to Commanding General, U. S. Army Mobility Equipment Command ATTN: AMSME-MPD 4300 Goodfellow Blvd. St. Louis, Mo. 63120.

SECTION 2

PRESCRIBED LOAD ALLOWANCE

(1) Federal stock number	(2) Description	(8) 15-day org maint alw			
		(A) 1-5	(B) 6-20	(C) 21-60	(D) 51-100
3030-233-6924	BELT, V (08288) MSS3030-6	*	*	2	2
4710-277-5526	TUBE, COPPER 0.313 in. dia.	*	*	2	2

LINE NO	(1) SOURCE, MAINT. AND RECOV. CODE			(2) FEDERAL STOCK NUMBER	(3) DESCRIPTION	(4) UNIT OF ISSUE	(5) QTY INC IN UNIT PACK	(6) QTY INC IN UNIT	(7) 15 DAY ORG. MAINT. ALW.				(8) ILLUSTRATION			
	(a) S	(b) M	(c) R						MANUFACTURER'S		(a) 1-5	(b) 6-20	(c) 21-50	(d) 51-100	(a) FIG. NO.	(b) ITEM OR SYM. NO.
									CODE	PART NUMBER						
0001					SECTION 3 - REPAIR PARTS LIST, ORGANIZATIONAL LEVEL											
0002					GROUP 18 - BODY CAB; HOOD; HULL											
0003					1808 - STOWAGE RACKS, BOXES, STRAPS											
0004	X2	0			BOX, TOOL	52565	0P1052	EA	1	*	*	*	*			
0005					GROUP 22 - BODY, CHASSIS OR HULL, AND ACCESSORY ITEMS											
0006					2210 - DATA PLATES AND INSTRUCTION HOLDERS											
0008	X2	0			PLATE, IDENTIFICATION: ELECTRIC WIRING	52565	0PE503	EA	1	*	*	*	*			
0009	X2	0			PLATE, IDENTIFICATION: ELECTRIC WIRING	52565	PLBE504	EA	1	*	*	*	*			
0010	X2	0			PLATE, IDENTIFICATION: CONTROL (GE)	24446	132377	EA	1	*	*	*	*			
0011	X2	0			PLATE, IDENTIFICATION: LIMIT SWITCH (GE)	24446	41799	EA	1	*	*	*	*			
0012	X2	0			PLATE, IDENTIFICATION: MASTER UMIBRAKE	38740	61915	EA	1	*	*	*	*			
0013					GROUP 40 - ELECTRIC MOTORS											
0014					4000 - MOTOR ASSEMBLY											
0016	X2	0	R		MOTOR: SQUIRREL CAGE INDUCTION W/UNIBRAKE; 1 HP 220/440 PH, 860RPM, FRAME No. 225, 1 in. SHAFT. (ELECTRIC MOTORS AND REPAIR PARTS ARE TO BE REQUISITIONEO BY COMPLETE IDENTIFYING NOMENCLATURE, COMPLETE MOTOR AND FRAME NAMEPLATE DATA MUST BE SHOWN ON THE REQUISITION TO INSURE SUPPLY OF THE PROPER REPAIR PARTS OR MOTOR)	52565	OP1070	EA	1	*	*	*	*	1	3	
0017		0		5310-685-1429	NUT, PLAIN, HEXAGON: MOTOR MTG			EA	4	*	*	*	*	1	14	
0021		0		5305-017-9887	SCREW, CAP, HEXAGON HEAD: MOTOR MTG			EA	4	*	*	*	*	1	12	
0023		0		5310-010-3323	WASHER, LOCK: MOTOR MTG			EA	4	*	*	*	*			
0024					4007 - DRIVE COMPONENTS											
0025	P	0		3030-233-6924	BELT, V	08288	MSS3030-6	EA	2	*	*	2	2	1	4	
0026	X2	0			KEY, MACHINE: PULLEY DRIVE	52565	0P1049	EA	1	*	*	*	*			
0027	X2	0			PULLEY, GROOVE: MOTOR DRIVE	52565	0P1035	EA	1	*	*	*	*	1	2	
0073					GROUP 65 - REPRODUCTION EQUIPMENT COMPONENTS											
0074					6503 - OFFSET MAIN PRESS ASSEMBLY											
0075	X2	0		4730-202-8003	ADAPTER, STRAIGHT, PIPE TO TUBE: OIL LINE	79470	68X5	EA	8	*	*	*	*			

LINE NO	(1) SOURCE, MAINT. AND RECOV. CODE			(2) FEDERAL STOCK NUMBER	(3) DESCRIPTION	(4) UNIT OF ISSUE	(5) QTY INC IN UNIT PACK	(6) QTY INC IN UNIT	(7) 15 DAY ORG. MAINT. ALW.				(8) ILLUSTRATION			
	(a) S	(b) M	(c) R						MANUFACTURER'S		(a) 1-5	(b) 6-20	(c) 21-50	(d) 51-100	(a) FIG. NO.	(b) ITEM OR SYM. NO.
									CODE	PART NUMBER						
0076	X2	0		4730-595-2634	ADAPTER, STRAIGHT, PIPE TO TUBE: OIL LINES RH AND LH CARRIAGE FRAMES	EA	4	*	*	*	*					
0077	X2	0		3610-353-5633	BAR, CLAMP, BLANKET SHAFT: CYLINDER	EA	2	*	*	*	*	12	4			
0078	X2	0			BAR, CLAWI CYLINDER BLANKET	EA	2	*	*	*	*	12	1			
0086	P	0		3610-353-5627	BLANKET, CYLINDER	EA	1	2	2	4	8	12	2			
0092	P	0		5306-274-3175	BOLT, SHOULDER: LIFT LEVER TO LINK	EA	2	*	*	*	*	9	4			
0103	X2	0		5340-353-5622	CLAMP: OIL LINES	EA	5	*	*	*	*					
0104	X2	0			CUP, LUBRICATION	EA	2	*	*	*	*					
0105	X2	0			CUP, LUBRICATION	EA	2	*	*	*	*					
0106	X2	0		4730-278-9438	CUP, OIL, LUBRICATING: CARRIAGE END FRAMES	EA	8	*	*	*	*					
0107	X2	0		4730-174-4518	CUP, OIL, LUBRICATING: ECCENTRIC BEARING RH, LN	EA	2	*	*	*	*					
0111		0		4730-277-8265	ELBOW, PIPE: ECCENTRIC BEARING, RH, LN	EA	2	*	*	*	*					
0123	P	0		3610-346-3000	GRIPPER, PRINTING BED	EA	6	*	2	2	3	4	10			
0124	X2	0			GUARD, PULLEY	EA	1	*	*	*	*					
0125	X2	0			GUARD, DRIVE SHAFT	EA	1	*	*	*	*	7	2			
012B	X2	0			GUIDE, INDEX, PRINTING BED	EA	1	*	*	*	*	5	5			
0129	X2	0			HANDWHEEL	EA	1	*	*	*	*	1	9			
0130	X2	0			HANDWHEEL: PLATE BED	EA	2	*	*	*	*	3	8			
0133	x2	0			KEY, MACHINE: PINION GEAR TO HANDWHEEL	EA	1	*	*	*	*	7	12			
0135	X2	0			LEVER, CYLINDER LIFT: SHAFT, LN	EA	1	*	*	*	*	9	8			
0136	X2	0			LEVER, CYLINDER LIFT: SHAFT, RH	EA	1	*	*	*	*					
0137	X2	0			LEVER, GRIPPER: GRIPPER SNAFT	EA	1	*	*	*	*	4	5			
0138	X2	0			LEVER, TREADLE	EA	1	*	*	*	*	6	9			
0190	X2	0			LINK, GRIPPER LEVER: TREADLE LEVER	EA	1	*	*	*	*	6	10			
0142		0		5310-010-2637	NUT, PLAIN, HEXAGON: LIFT LEVER TO LINK	EA	2	*	*	*	*	9	6			
0145		0		5310-010-2637	NUT, PLAIN, HEXAGON: LINK MTG TO TREADLE AND GRIPPER LEVER	EA	2	*	*	*	*	6	2			
0147	X2	0		5310-389-6462	NUT, PLAIN, KNURLED: ADJUSTINO STUD	EA	2	*	*	*	*	5	1			
0148	X2	0		5310-274-7879	NUT, PLAIN, ROUND: PRINTING BED	EA	4	*	*	*	*	4	9			
0149	X2	0		5310-278-7874	NUT, PLAIN, ROUND: PRINTING BED, STOP	EA	4	*	*	*	*	4	8			
0157		0		5315-198-5988	PIN, TAPERED, PLAIN: CYLINDER LFT LEVER TO SHAFT	EA	2	*	*	*	*	9	9			
0159		0		5315-198-5974	PIN, TAPERED, PLAIN: GRIPER LEVER AND TREADLE LEVER	EA	2	*	*	*	*	4	6			
0160		0		5315-198-5982	PIN, TAPERED, PLAIN: TREADLE GRIPPER, LH, RN	EA	2	*	*	*	*	6	5			
0163	X2	0			PULLEY, GROOVE: DRIVING PINION	EA	1	*	*	*	*	1	7			
0176		0		5305-017-9885	SCREW, CAP, HEXAGON HEAD: LINK NTG TO TREADLE AND GRIPPER LEVER	EA	2	*	*	*	*	6	1			
0186		0		5305-013-8252	SCREW, CAP, SOCKET HEAD: HANDWHEEL TO PINION DRIVE GEAR NYTG	EA	3	*	*	*	*	1	8			
0189		0		5305-275-9840	SCREW, MACHINE: BAR CLAMP TO CYLINDER BLANKET NTG	EA	16	*	*	*	*	12	3			
0192		0		5305-011-0499	SCREW, MACHINE: DRIVE SNHAFT GUARD MTG	EA	2	*	*	*	*	7	1			
0194		0		5305-685-1344	SCREW, MACHINE: GUIDE ARM SHAFT	EA	2	*	*	*	*	5	7			
0195		0		5305-011-4703	SCREW, MACHINE: PINION DRIVING GEAR TO PULLEY	EA	3	*	*	*	*	7	11			

LINE NO	(1) SOURCE, MAINT. AND RECOV. CODE			(2) FEDERAL STOCK NUMBER	(3) DESCRIPTION	(4) UNIT OF ISSUE	(5) QTY INC IN UNIT	(6) QTY INC IN UNIT	(7) 15 DAY ORG. MAINT. ALW.				(8) ILLUSTRATION			
	(a) S	(b) M	(c) R						MANUFACTURER'S		(a) 1-5	(b) 6-20	(c) 21-50	(d) 51-100	(a) FIG. NO.	(b) ITEM OR SYM. NO.
									CODE	PART NUMBER						
0196		0		5305-012-0628	SCREW, MACHINE: PULLEY GUARD NTC	EA		5	*	*	*	*				
0198		0		5305-010-2594	SETSCREW: GRIPPER	EA		6	*	*	*	*	4	11		
0200		0		5305-010-2595	SETSCREW: TREADLE LEVER	EA		1	*	*	*	*	6	7		
0203	X2	0			SHAFT: GUIDE ARM	EA	52565 0P250	1	*	*	*	*	5	6		
0204	X2	0			SHAFT: TREADLE, FOOT	EA	52565 0P28	1	*	*	*	*	6	6		
0207	X2	0			SPACER: HAND WHEEL	EA	52565 0P1026	1	*	*	*	*				
0210	X2	0		3610-531-7277	SPRING, HELICAL, EXTENSION: GRIPPER TO TREADLE SHAFT LEVER	EA	52565 THX129	1	*	*	*	*	6	3		
0215	X2	0		5307-353-5630	STUD, GUIDE ADJUSTING	EA	52565 0P276	1	*	*	*	*	5	3		
0216	X2	0			STUD, PLAIN: HANDWHEEL	EA	52565 0P290	2	*	*	*	*	3	9		
0219	X2	0			SUPPORT, INDEX GUIDE	EA	52565 0P229	1	*	*	*	*	5	2		
0220		0		5305-639-8108	THUMBSCREW: INDEX GUIDE SUPPORT	EA		1	*	*	*	*	5	8		
0221	X2	0			TREADLE, GRIPPER: LH	EA	52565 0P232L	1	*	*	*	*	6	8		
0222	X2	0			TREADLE, GRIPPER: RH	EA	52565 0P232R	1	*	*	*	*	6	4		
0225	M	0			TUBE, COPPER: OIL ECCENTRIC BEARING	EA	52565 0P1062	2								
0225A	P	0		4710-277-5526	TUBE, COPPER (10 in. REQUIRED FOR EACH)	FT			SEE	GRP	9501					
0226	M	0			TUBE, COPPER: OIL, FRONT CARRIAGE RH, LN WHEEL BEARING	EA	52565 0P1063	2								
0226A	P	0		4710-277-5526	TUBE, COPPER (26 in. REQUIRED FOR EACH)	FT			SEE	GRP	9501					
0227	M	0			TUBE, COPPER: OIL, REAR CARRIAGE RH AND LH WHEEL BEARING	EA	52565 0P1064	2								
0227A	P	0		41710-277-5526	TUBE, COPPER (34 in. REQUIRED FOR EACH)	FT			SEE	GRP	9501					
0228	M	0			TUBE, COPPER: OIL, PINION STUD	EA	52565 0P1065	2					9	2		
0228A	P	0		4710-277-5526	TUBE, COPPER (20 in. REQUIRED FOR EACH)	FT			SEE	GRP	9501					
0229		0		5310-010-0308	WASHER, FLAT: PINION DRIVING GEAR TO PULLEY	EA		3	*	*	*	*	7	10		
0235					GROUP 95 - GENERAL USE STANDARDIZED PARTS											
0236					9501 - BULK MATERIAL											
0240	P	0		4710-277-5526	TUBE, COPPER: 0.313 in. DIA	FT			*	*	2	2				

LINE NO	(1) SOURCE, MAINT. AND RECOV. CODE			(2) FEDERAL STOCK NUMBER	(3) DESCRIPTION	(4) UNIT OF ISSUE	(5) QTY INC IN UNIT	(6) QTY INC IN UNIT	(7) 15 DAY ORG. MAINT. ALW.				(8) ILLUSTRATION			
	(a) S	(b) M	(c) R						MANUFACTURER'S		(a)	(b)	(c)	(d)	(a)	(b)
									CODE	PART NUMBER						
									1-5	6-20						
0242					SECTION 4 - SPECIAL TOOLS, TEST AND SUPPORT EQUIPMENT, ORGANIZATIONAL LEVEL											
0242A					GROUP 26 - TOOLS AND TEST EQUIPMENT											
0243					2604 - SPECIAL TOOLS											
0243A					NOTE: IF THESE TOOLS ARE NOT A COMPONENT OF AUTHORIZED TA OR TOE TOOLSETS, A QUANTITY NECESSARY FOR THE PERFORMANCE OR ASSIGNED MAINTENANCE MISSION IS AUTHORIZED FOR EACH ORGANIZATIONAL MAINTENANCE FACILITY											
0244	X2	0			CRANK: CARRIAGE	52565	0P221	EA	1	*	*	*	*			
0245	X1				GRIP: CARRIAGE CRANK	52565	0P265	EA	1							
0246	X1				STUD, CRANK	52565	THX107	EA	1							
0247	X1				WASHER, CRANK	52565	0P264	EA	1							
0248	X2	0			EDGE, STRAIGHT	52565	0P281-1	EA	1	*	*	*	*			
0249	P	0	5210-277-8840		INDICATOR, DIAL: TEST	08288	MSS5210-3	EA	1	*	*	7	2			
0250	X2	0	5120-240-7308		BLOCK, BENCH	08288	MSS5120-1	EA	1	*	*	*	*			
0251	X2	0			NUT: BENCH BLOCK	52565	0P1069	EA	1	*	*	*	*			
0252	X2	0			PIN, STRAIGHT, HEADLESS: 3/8 in. DIA, 9 in. LG	52565	0P1001	EA	1	*	*	*	*			
0253	X2	0			SLEEVE: 3/8 HOLE	52565	0P1003	EA	1	*	*	*	*			
0254	X2	0			STUD, INDICATOR	52565	0P1000	EA	1	*	*	*	*			
0255		0	5310-012-0393		WASHER, FLAT			EA	1	*	*	*	*			
0256	X2	0			WRENCH: REEL ROD	52565	0P272	EA	1	*	*	*	*			
0257	X2	0			WRENCH: WHEEL	52565	0P279	EA	1	*	*	*	*			

LINE NO	(1) SOURCE, MAINT. AND RECOV. CODE			(2) FEDERAL STOCK NUMBER	(3) DESCRIPTION	(4) UNIT OF ISSUE	(5) QTY INC IN UNIT PACK	(6) QTY INC IN UNIT	(7) 15 DAY ORG. MAINT. ALW.			(8) 1-YR ALW PER100 EQUIP CTYGCY PLANNING	(9) DEPOT MAINT. ALW. PER 100 EQUIP	(10) ILLUSTRATION			
	(a) S	(b) M	(c) R						MANUFACTURER'S		(a) 1-20			(b) 21-50	(c) 51-100	(a) FIG. NO.	(b) ITEM OR SYM. NO.
									CODE	PART NUMBER							
0001					SECTION 5 - REPAIR PARTS LIST, DS, GS, AND DEPOT LEVEL												
0002					GROUP 18 - BODY CAB; HOOD; HULL												
0003					1808 - STOWAGE RACKS, EOXES, STRAPS												
0004	X2	0			BOX, TOOL	52565	0P1052	EA	1	*	*	*	*	*			
0005					GROUP 22 - BODY, CHASSIS OR HULL, AND ACCESSORY ITEMS												
0006					2210 - DATA PLATES AND INSTRUCTION HOLDERS												
0007	X2	F		9908-03-9431	PLATE, IDENTIFICATION: CORPS OF ENGINEERS			EA	1	*	*	*	*	*			
0008	X2	0			PLATE, IDENTIFICATION: ELECTRIC WIRING	52565	0PE503	EA	1	*	*	*	*	*			
0009	X2	0			PLATE, IDENTIFICATION: ELECTRIC WIRING	52565	PLBE504	EA	1	*	*	*	*	*			
0010	X2	0			PLATE, IDENTIFICATION: CONTROL (GE)	24446	132377	EA	1	*	*	*	*	*			
0011	X2	0			PLATE, IDENTIFICATION: LIMIT SWITCH (GE)	24446	41799	EA	1	*	*	*	*	*			
0012	X2	0			PLATE, IDENTIFICATION: MASTER UNIBRAKE	38740	61915	EA	1	*	*	*	*	*			
0013					GROUP 40 - ELECTRIC MOTORS												
0014					40000 - MOTOR ASSEMBLY												
0015	X2	F			HINGE: MOTOR BASE PLATE	52565	0P1030	EA	2	*	*	*	*	*	1	5	
0016	X2	0	R		MOTOR: SQUIRREL CAGE INDUCTION W/UIBRAKE; 1 HP 220/440 PH, 86ORP, FRAME No. 225, 1 in. SHAFT. (ELECTRIC MOTORS ANO REPAIR PARTS ARE TO BE REQUISITIONED BY COMPLETE IDENTIFYING NOMENCLATURE. COMPLETE MOTOR AND FRAME NAMEPLATE DATA MUST BE SHOWN ON THE REQUISITION TO INSURE SUPPLY OF THE PROPER REPAIR PARTS OR MOTOR)	52565	0P1070	EA	1	*	*	*	*	*	1	3	
0017		0		5310-685-1429	NUT, PLAIN, HEXAGON: MOTOR MTG			EA	4	*	*	*	*	*	1	14	
0018	X2	F			PLATE: MOTOR MTO	52565	0P1034	EA	1	*	*	*	*	*	1	13	
0019	X2	F			ROD, HINGE: MOTOR BASE PLATE	52565	0P1029	EA	1	*	*	*	*	*			
0020	X2	F			SCREW, ADJUSTING: MOTOR PLATE	52565	0P1036	EA	1	*	*	*	*	*			
0021		0		5305-017-9887	SCREW, CAP, HEXAGON HEAD: MOTOR MTG			EA	4	*	*	*	*	*	1	12	
0022		F		5305-978-9394	SCREW, CAP, SOCKET HEAD: MOTOR BASE HINGE			EA	4	*	*	*	*	*			

LINE NO	(1) SOURCE, MAINT. AND RECOV. CODE			(2) FEDERAL STOCK NUMBER	(3) DESCRIPTION	(4) UNIT OF ISSUE	(5) QTY INC IN UNIT PACK	(6) QTY INC IN UNIT	(7) 15 DAY ORG. MAINT. ALW.			(8) 1-YR ALW PER100 EQUIP CTYGCY PLANNING	(9) DEPOT MAINT. ALW. PER 100 EQUIP	(10) ILLUSTRATION			
	(a) S	(b) M	(c) R						MANUFACTURER'S		(a) 1-20			(b) 21-50	(c) 51-100	(a) FIG. NO.	(b) ITEM OR SYM. NO.
									CODE	PART NUMBER							
0023		0		5310-010-3323	WASHER, LOCK: MOTOR MTG	EA		4	*	*	*	*	*				
0024					4007 - DRIVE COMPONENTS												
0025	P	0		3030-233-6924	BELT, V	EA		2	2	2	3	30	6	1	4		
0026	X2	0			KEY, MACHINE: PULLEY DRIVE	EA		1	*	*	*	*	*				
0027	X2	0			PULLEY, GROOVE: MOTOR DRIVE	EA		1	*	*	*	*	*	1	2		
0028					4010 - MASTER OR 'AUXILIARY CONTROL ASSEMBLY												
0029	X2	F			PLATE: SWITCH AND BRAKE	EA		1	*	*	*	*	*				
0030		F		5305-273-5249	SCREW, CAP, SOCKET HEAD: ANGLE MTG	EA		2	*	*	*	*	*				
0031	X2	F			STARTER: REVERSING	EA		1	*	*	*	*	*	1	1		
0032	P	F		3610-884-4748	COIL: MAGNETIC	EA		2	2	2	3	41	20				
0033	F			5945-241-7738	CONTACT: FRONT, NORMALLY OPEN	EA		8	3	7	13	160	80				
0034	P	F		5945-395-2509	CONTACTS: MOVABLE, NORMALLY OPEN	EA		8	3	7	13	160	80				
0035	X2	F			CONTACTS: REAR, NORMALLY OPEN	EA		8	*	*	*	*	*				
0036	P	F		3610-884-4749	HEATER UNIT	EA		2	*	2	2	20	10				
0037	X2	F			RELAY, THERMAL	EA		2	*	*	*	*	*				
0038	X2	F			STEEL ANGLE: STARTER	EA		2	*	*	*	*	*				
0039	P	F		5930-262-9957	SWITCH, PUSH: FORWARD, REVERSE AND STOP	EA		2	2	2	3	30	6	1	11		
0040	X2	F			BUTTON, PUSH: SLOCK	EA		4	*	*	*	*	*				
0041	X2	F			BUTTON, PUSH: ROD	EA		2	*	*	*	*	*				
0042	P	F		5930-112-5272	SWITCH, TOGGLE: MOTOR	EA		1	*	2	2	15	6				
0043					4011 - CIRCUIT BREAKERS, CUTOUTS, FUSE AND FUSEHOLDERS												
0044	X2	F			BREAKER, BAR: LIMIT SWITCH	EA		2	*	*	*	*	*	2	5		
0045		F		5305-543-4527	SCREW, CAP, SOCKET HEAD: BREAKER BAR ADJUSTING	EA		4	*	*	*	*	*	2	8		
0046		F		5305-021-7910	SCREW, CAP, SOCKET HEAD: LIMIT SWITCH BREAKER SUPPER	EA		8	*	*	*	*	*	2	7		
0047	X2	F		5930-371-4562	SUPPORT, LIMIT SWITCH BREAKER: LH	EA		1	*	*	*	*	*	2	6		
0048	X2	F			SUPPORT, LIMIT SWITCH BREAKER: RH	EA		1	*	*	*	*	*				
0049	X2	F			SUPPORT: LIMIT SWITCH BREAKER	EA		1	*	*	*	*	*				
0050	P	F		5930-328-5558	SWITCH, SENSITIVE, LIMIT: CYLINDER OVER TRAVEL	EA		1	*	2	2	15	6				
0051	P	F		5930-024-2161	SWITCH, SENSITIVE, LIMIT: CYLINDER OVER TRAVEL	EA		1	*	2	2	15	6	1	10		

LINE NO	(1) SOURCE, MAINT. AND RECOV. CODE			(2) FEDERAL STOCK NUMBER	(3) DESCRIPTION	(4) UNIT OF ISSUE	(5) QTY INC IN UNIT PACK	(6) QTY INC IN UNIT	(7) 15 DAY ORG. MAINT. ALW.			(8) 1-YR ALW PER100 EQUIP CTYGCY PLANNING	(9) DEPOT MAINT. ALW. PER 100 EQUIP	(10) ILLUSTRATION			
	(a) S	(b) M	(c) R						MANUFACTURER'S		(a) 1-20			(b) 21-50	(c) 51-100	(a) FIG. NO.	(b) ITEM OR SYM. NO.
									CODE	PART NUMBER							
0052					4018 - TERMINAL BLOCKS, JUNCTION BOXES												
0053	M	F			CABLE	EA											
					MANUFACTURE FROM:												
0053A	P	F		2610-979-7455	CABLE, SPECIAL PURPOSE, ELECTRICAL (15 FT REQUIRED)	FT			SEE	GRP	9501						
0054	M	F			CABLE, POWER, ELECTRICAL	EA		1									
					MANUFACTURE FROM:												
0054A	P	F		3610-979-7454	CABLE, POWER, ELECTRICAL (36 in. REQUIRED)	FT			SEE	GRP	9501						
0055	X2	F			CAP, ELECTRICAL	EA		8	*	*	*	*	*				
0056	X2	F			CONDUIT, FLEXIBLE: STARTER TO MOTOR, 1/2 in. (10 in. LG REQUIRED)	EA		1	*	*	*	*	*				
					CONNECTOR: ELECTRICAL CONDUIT	EA		2	*	*	*	*	*				
0058	X2	F		5975-050-6822	CONNECTOR: ELECTRICAL, STARTER TO MOTOR	EA		2	*	*	*	*	*				
				5975-152-1072	FLEXIBLE CONDUIT, 1/2 IN.	EA		2	*	*	*	*	*				
0059	X2	F			CONNECTOR, RECEPTACLE, ELECTRICAL	EA		1	*	*	*	*	*				
0060	X2	F			CONNECTOR: 90 DEQ	EA		2	*	*	*	*	*				
0061	X2	F			COVER: CONDUIT	EA		1	*	*	*	*	*				
0062	X2	F			ELBOW: ELECTRICAL CONDUIT	EA		1	*	*	*	*	*				
0063	X2	F		5975-893-8544	ELBOW, ELECTRICAL CONDUIT	EA		4	*	*	*	*	*				
0064	X2	F		5970-884-4783	INSULATOR, WASHER	EA		8	*	*	*	*	*				
0065	X2	F		5975-280-3194	NIPPLE, ELECTRICAL CONDUIT	EA		1	*	*	*	*	*				
0066	X2	F			REDUCER: CONDUIT, 1 in. TO 1/2 IN.	EA		4	*	*	*	*	*				
0067	X2	F		5340-254-2890	STRAP, RETAINING: CONDUIT	EA		1	*	*	*	*	*				
0068	X2	F			TEE, TUBELET: ELECTRICAL	EA		1	*	*	*	*	*				
0069	X2	F			TERMINAL, LUG	EA		4	*	*	*	*	*				
0070	X2	F			TUBING: STARTER TO SWITCHES, 3/4 IN. (3 FT REQUIRED)	EA		1	*	*	*	*	*				
0071	X2	F			TUBING: 1/2 in. DIA (3 FT REQUIRED)	EA		1	*	*	*	*	*				
0072	M	F			WIRE	EA		1									
					MANUFACTURE FROM:												
0072A	P	F		6145-146-6756	WIRE, ELECTRICAL (75 FT REQUIRED)	FT			SEE	GRP	9501						
0073					GROUP 65 - REPRODUCTION EQUIPMENT COMPONENTS												
0074					6503 - OFFSET MAIN PRESS ASSEMBLY												
0075	X2	0		4730-202-8003	ADAPTER, STRAIGHT, PIPE TO TUBE: OIL LINE	EA		8	*	*	*	*	*				
0076	X2	0		4730-595-2634	ADAPTER, STRAIGHT, PIPE TO TUBE: OIL LINES, RN AND LM CARRIAGE FRAMES	EA		4	*	*	*	*	*				

LINE NO	(1) SOURCE, MAINT. AND RECOV. CODE			(2) FEDERAL STOCK NUMBER	(3) DESCRIPTION	(4) UNIT OF ISSUE	(5) QTY INC IN UNIT PACK	(6) QTY INC IN UNIT	(7) 15 DAY ORG. MAINT. ALW.			(8) 1-YR ALW PER100 EQUIP CTYGCY PLANNING	(9) DEPOT MAINT. ALW. PER 100 EQUIP	(10) ILLUSTRATION			
	(a) S	(b) M	(c) R						MANUFACTURER'S		(a) 1-20			(b) 21-50	(c) 51-100	(a) FIG. NO.	(b) ITEM OR SYM. NO.
									CODE	PART NUMBER							
									ISSUE	PACK							
0077	X2	0		3610-353-5633	BAR, CLAW, BLANKET SHAFT: CYLINDER	52565	0P293	EA		2	*	*	*	12	4		
0078	X2	0			BAR, CLAW: CYLINDER BLANKET	52565	0P292	EA		2	*	*	*	*	12	1	
0079	X2	F			BAR, CLAMPING	52565	0P202	EA		1	*	*	3	.			
0080	X2	H			BAR, TIE: SIDE FRAME, END AND CENTER	52565	0P246	EA		2	2	*	*	2	23		
0081	P	H		3610-371-4556	BEARER, CYLINDER: LH	52565	0P213L	EA		1	*	2	7	4	11	1	
0082	P	H		3610-371-4557	BEARER, CYLINDER: RH	52565	0P213R	EA		1	*	2	7	1 ii	6		
0083	P	F		3110-271-0212	BEARING, ROLLER, JOURNAL: CARRIAGE WHEEL	52565	0P262	EA		3	7	13	10	2			
0084	P	F		3610-288-2208	BEARING, SLEEVE: PINION STUD	52565	0P277	EA		1	2	2	4	45	10	7	8
0085	X2	F			BED, PRINT	52565	0P203	EA		1	*	*	*	*	*	4	1
0086	P	0		3610-353-5627	BLANKET, CYLINDER	52565	0P267	EA		1	4	8	17	200	100	12	2
0087	X2	F			BLOCK, ECCENTRIC ADJUSTING	52565	0P1012-1	EA		2	*	*	*	*	*	9	5
0088	X2	F			BLOCK, LATCH: RH CARRIAGE END FRAME	52565	0P230	EA		1	*	*	*	*	*		
0089	X2	F		5306-353-5623	BOLT, MACHINE: END BRACE, CENTER BRACE	52565	THX016	EA		4	*	*	*	*	*	3	3
0090	P	F		530346-3 023	BOLT, SHOULDER: CARRIAGE WNEEL, ECCENTRIC, RH FRAME	52565	0P263	EA		4	*		2	2	16	8	
0091	P	F		5306-27.3171	BOLT, SHOULDER: ECCENTRIC ARM	52565	0P271	EA		2	*	*	2	8	4	8	5
0092	P	0		5306-274-3175	BOLT, SHOULDER: LIFT LEVER TO LINK	52565	0P1010-1	EA		2	*	*	2	8	4	9	4
0093	X2	H			BRACE, CENTER: SIDE FRAMES	52565	0P206	EA		1	*	*	*	*	*	2	24
0094	X2	H			BRACE, END: PLATE BED	52565	0P205	EA		1	*	*	*	*	*	2	14'
0095	X2	H			BRACE, END: PRINTING BED, FRONT	52565	0P242	EA		1	*	*	*	*	*	2	22
0096	X2	H			BRACE: TOP CARRIAGE	52565	0P204	EA		1	*	*	*	*	*	8	3
0097	X2	F			BRACKET, CLAW: CLAMPING BAR	52565	0P228	EA		4	*	*	*	*	*	3	6
0098	X2	F			BRACKET: GRIPPER SHAFT	52565	0P226	EA		1	*	*	*	*	*	4	7
0099	X2	F		3610-37-2975	BRACKET, GRIPPER SHAFT: LH	52565	0P22L	EA		1	*	*	*	*	*	4	2
0100	X2	F		3610-374-2976	BRACKET, GRIPPER SHAFT: RH	52565	0P222R	EA		1	*	*	*	*	*	4	12
0101	X2	F			CAP, END: CYLINDER SNAFT	52565	0P269	EA		2	*	*	*	*	*	8	7
0102	X2	F			CLAMP, ADJUSTING: PLATE BED	52565	0P227	EA		2	*	*	*	*	*	3	10
0103	X2	0		5310-353-5622	CLAMP: OIL LINES	52565	RLB450	EA		5	*	*	*	*	*		
0104	X2	0			CUP, LUBRICATION	52565	0P1149	EA		2	*	*	*	*	*		
0105	X2	0			CUP, LUBRICATION	52565	0P1150	EA		2	*	*	*	*	*		
0106	X2	0		4730-278-9438	CUP, OIL, LUBRICATING: CARRIAGE END FRAMES	24981	1219	EA		8	*	*	*	*	*		
0107	X2	0		4730-17L1-518	CUP, OIL , LUBRICATING: ECCENTRIC BEARING RH, LH	52565	0P1147	EA		2	*	*	*	*	*		
0108	X2	H			CYLINIER	52565	0P299	EA		1	*	*	*	*	*	11	5
0109	X2	H			ECCENTRIC, BEARING: CYLINDER, RH	52565	0P209	EA		1	*	*	*	*	*	8	6
0110	X2	H			ECCENTRIC, CYLINDER BEARING: LH	52565	0P231	EA		1	*	*	*	*	*	9	3
0111	0			4730-277-8265	ELBOW, PIPE: ECCENTRIC BEARING, RH, LH	79470	3400X2	EA		2	*	*	*	*	*		
0112	X2	H			FRAME: CARRIAGE, LH	52565	0P208	EA		1	*	*	*	*	*	9	1
0113	X2	H			FRAME: CARRIAGE, RH	52565	0P207	EA		1	*	*	*	*	*	8	2
0114	X2	H			FRAME: SIDE	52565	0P201RH	EA		1	*	*	*	*	*	2	20
0115	X2	H			FRAME: SIDE, RH	52565	0P201LH	EA		1	*	*	*	*	*	2	1
0116	X2	F			GEAR, DRIVE: CARRIAGE DRIVE SHAFT	52565	0P211	EA		1	*	*	*	*	*	1	6
0117	X2	H			GEAR, PINION: CARRIAGE DRIVE SHAFT	52565	0P296	EA		2	*	*	*	*	*	7	3
0118	X2	F			GEAR, PINION DRIVING: PINION STUD	52565	0P273	EA		1	*	*	*	*	*	7	9

LINE NO	(1) SOURCE, MAINT. AND RECOV. CODE			(2) FEDERAL STOCK NUMBER	(3) DESCRIPTION	(4) UNIT OF ISSUE	(5) QTY INC IN UNIT PACK	(6) QTY INC IN UNIT	(7) 15 DAY ORG. MAINT. ALW.			(8) 1-YR ALW PER100 EQUIP CTYGCY PLANNING	(9) DEPOT MAINT. ALW. PER 100 EQUIP	(10) ILLUSTRATION			
	(a) S	(b) M	(c) R						MANUFACTURER'S		(a) 1-20			(b) 21-50	(c) 51-100	(a) FIG. NO.	(b) ITEM OR SYM. NO.
									CODE	PART NUMBER							
									ISSUE	PACK							
0119	X2	H			GEAR, SPUR: BLANKET ADJUSTING END	EA		1	*	*	*	*	*	10	5		
0120	X2	H			GEAR, SPUR: DRIVE END	EA		1	*	*	*	*	*				
0121	X2	H			GEAR, RACK: SIDE FRAME	EA		4	*	*	*	*	*	2	2		
0122	X2	F			GIB: PRINTING BED AND PLATE	EA		2	*	*	*	*	*	3	2		
0123	P	0		3610-346-3000	GRIPPER, PRINTING BED	EA		6	2	3	5	60	30	4	10		
0124	X2	0			GUARD, PULLEY	EA		1	*	*	*	*	*				
0125	X2	0			GUARD, DRIVE SHAFT	EA		1	*	*	*	*	*	7	2		
0126	X2	F		3610-374-2977	GUIDE, BED ADJUSTING SCREW: LH	EA		1	*	*	*	*	*				
0127	X2	F		3610-374-2978	GUIDE, BED ADJUSTING SCREW: RH	EA		1	*	*	*	*	*	3	14		
0128	X2	0			GUIDE, INDEX, PRINTING BED	EA		1	*	*	*	*	*	5	5		
0129	X2	0			HANDWHEEL	EA		1	*	*	*	*	*	1	9		
0130	X2	0			HANDWHEEL: PLATE BED	EA		2	*	*	*	*	*	3	8		
0131	X2	F			HOOK, SPRING: TREADLE LINKAGE	EA		2	*	*	*	*	*				
0132	M	F			KEY, MACHINE: DRIVE GEAR TO CARRIAGE SHAFT	EA		1						7	7		
					MANUFACTURE FROM:												
0132	X2	F		9510-229-4849	STEEL BAR, CARBON, COLD FINISHED	FT			SEE	GRP	9501						
0133	X2	0			KEY, MACHINE: PINION GEAR TO NANDWHEEL	EA		1	*	*	*	*	*	7	12		
0134		F		5315-246-9722	KEY, MACHINE: SHAFT TO PINION GEAR	EA		2	*	*	*	*	*	7	4		
0135	X2	0			LEVER, CYLINDER LIFT: SNAFT, LN	EA		1	*	*	*	*	*	9	8		
0136	X2	0			LEVER, CYLINDER LIFT: SHAFT, RN	EA		1	*	*	*	*	*				
0137	X2	0			LEVER, GRIPPER: GRIPPER SHAFT	EA		1	*	*	*	*	*	4	5		
0138	X2	0			LEVER, TREADLE	EA		1	*	*	*	*	*	6	9		
0139	X2	F		5306-374-2973	LINK, ECCENTRIC, ADJUSTING	EA		2	*	*	*	*	*	9	7		
0140	X2	0			LINK, GRIPPER LEVER: TREADLE LEVER	EA		1	*	*	*	*	*	6	10		
0141		F		5310-022-0083	NUT, PLAIN, HEXAGON: CARRIAGE WNEEL SHAFT	EA		4	*	*	*	*	*				
0142		0		5310-010-2637	NUT, PLAIN, HEXAGON: LIFT LEVER TO LINK	EA		2	*	*	*	*	*	9	6		
0143		F		5310-655-9544	NUT, PLAIN, HEXAGON: LIFT LEVER STOP MTG	EA		1	*	*	*	*	*	9	14		
0144		F		5310-010-2637	NUT, PLAIN, HEXAGON: LINK ADJUSTING, AND ECCENTRIC ARM STUD	EA		6	*	*	*	*	*	9	6		
0145		0		5310-010-2637	NUT, PLAIN, HEXAGON: LINK MTG TO TREADLE AND GRIPPER LEVER	EA		2	*	*	*	*	*	6	2		
0146		F		5310-022-0081	NUT, PLAIN, HEXAGON: PINION STUD	EA		1	*	*	*	*	*				
0147	X2	0		5310-389-6462	NUT, PLAIN, KNURLED: ADJUSTING STUD	EA		2	*	*	*	*	*	5	1		
0148	X2	0		5310-274-7879	NUT, PLAIN, ROUND: PRINTING BED	EA		4	*	*	*	*	*	4	9		
0149	X2	0		5310-274-7874	NUT, PLAIN, ROUND: PRINTING BED, STOP	EA		4	*	*	*	*	*	4	8		
0150	P	F		3610-377-4955	PAD, STOP BLOCK: LEATHER, SIDE FRAME, LN AND RN	EA		4	2	2	3	40	20				
0151	P	F		3610-997-6011	PAWL: REEL, TN AND LN RATCNET	EA		2	2	2	3	40	20	10	3		
0152		H		5315-013-7204,	PIN, COTTER: LOWER END TRUSS PIN	EA		2	*	*	*	*	*	2	19		
0153		H		5315-271-7566	PIN, STRAIGHT, HEADLESS: LOWER ENDS TRUSS TO UPPER TRUSS FRAME	EA		1	*	*	*	*	*	2	18		
0154		H		5315-010-3692	PIN, STRAIGHT, HEADLESS: RATCNET DOWEL	EA		2	*	*	*	*	*	10	4		
0155		F		5315-198-5975	PIN, TAPERED, PLAIN: CLAMP ADJUSTING	EA		2	*	*	*	*	*				

LINE NO	(1) SOURCE, MAINT. AND RECOV. CODE			(2) FEDERAL STOCK NUMBER	(3) DESCRIPTION	(4) UNIT OF ISSUE	(5) QTY INC IN UNIT PACK	(6) QTY INC IN UNIT	(7) 15 DAY ORG. MAINT. ALW.			(8) 1-YR ALW PER100 EQUIP CTYGCY PLANNING	(9) DEPOT MAINT. ALW. PER 100 EQUIP	(10) ILLUSTRATION			
	(a) S	(b) M	(c) R						MANUFACTURER'S		(a) 1-20			(b) 21-50	(c) 51-100	(a) FIG. NO.	(b) ITEM OR SYM. NO.
									CODE	PART NUMBER							
0156		F		5315-198-5976	PIN, TAPERED, PLAIN: CLAMP BRACKET TO SHAFT	EA		4	*	*	*	*	*	3	5		
0157		O		5315-198-5988	PIN, TAPERED, PLAIN: CYLINDER LIFT LEVER TO SHAFT	EA		2	*	*	*	*	*	9	9		
0158	P	H		5315-198-5991	PIN, TAPPERED, PLAIN: GEAR RACK	EA		16	*	*	*	*	*	2	3		
0159		O		5315-199-5974	PIN, TAPERED, PLAIN: GRIPER LEVER AND TREADLE LEVER	EA		2	*	*	*	*	*	4	6		
0160		O		5315-198-5982	PIN, TAPERED, PLAIN: TREADLE GRIPPER, LH, RN	EA		2	*	*	*	*	*	6	5		
0161	X2	F			PLATE: BED	EA	52565	0P295	1	*	*	*	*	3	1		
0162	P	F		3610-353-5631	PLUNGER, LATCH: LATCH BLOCK	EA	52565	0P286	1	*	*	2	6	3	8	10	
0163	X2	O			PULLEY, GROOVE: DRIVING PINION	EA	52565	0P1027	1	*	*	*	*	1	7		
0164	P	F		3610-997-6010	RATCHET: BLANKET REEL	EA	52565	0P239	2	2	2	3	0	20	10	1	
0165	X2	H			ROD, BLANKET REEL: LH	EA	52565	0P233	1	*	*	*	*	*	11	2	
0166	X2	H			ROD, BLANKET REEL: RH	EA	52565	0P234	1	*	*	*	*	*	11	4	
0167	X2	H			ROD, TIE: CARRIAGE FRAME, FRONT AND REAR	EA	52565	0P247	2	*	*	*	*	*	11	3	
0168	X2	F		5305-353-5628	SCREW, BED ADJUSTING: PLATE BED	EA	52565	0P268	8	*	*	*	*	*	3	16	
0170		H		5305-021-6059	SCREW, CAP, HEXAGON: SPUR GEAR AND CYLINDER BEARING MTO	EA			3	*	*	*	*	*	10	7	
0171		H		5305-591-9313	SCREW, CAP, HEXAGON HEAD: CARRIAGE FRAME TOP BRACE, RN, LN	EA			4	*	*	*	*	*	8	1	
0172		F		5305-577-5462	SCREW, CAP, HEXAGON HEAD: CYLINDER END CAP MTG	EA			2	*	*	*	*	*	8	8	
0173		H		5305-017-9933	SCREW, CAP, HEXAGON HEAD: END BRACE AND CENTER BRACE TO SIDE FRAME HTG	EA			24	*	*	*	*	*	2	15	
0174		F		5305-577-5462	SCREW, CAP, HEXAGON HEAD: LIFT LEVER STOP	EA			1	*	*	*	*	*	9	10	
0175		F		5305-017-9837	SCREW, CAP, HEXAGON HEAD: LIFT LEVER STOP MTG	EA			1	*	*	*	*	*	9	12	
0176		O		5305-017-9885	SCREW, CAP, HEXAGON HEAD: LINK MTG TO TREADLE AND GRIPPER LEVER	EA			2	*	*	*	*	*	6	1	
0177		F		5305-017-9841	SCREW, CAP, HEXAGON HEAD: PAWL RATCHET MTG	EA			2	*	*	*	*	*	10	2	
0178		H		5305-021-6059	SCREW, CAP, HEXAGON HEAD: SPUR GEAR AND CYLINDER BEARER, LH MTS	EA			3	*	*	*	*	*			
0179		F		5305-017-9885	SCREW, CAP, HEXAGON HEAD: STOP BLOCK	EA			12	*	*	*	*	*	2	10	
0180		H		5305-021-6059	SCREW, CAP, HEXAGON HEAD: TIE BAR TO SIDE FRAME	EA			4	*	*	*	*	*	2	21	
0181		H		5305-021-6061	SCREW, CAP, HEXAGON HEAD: TIE ROD TO CARRIAGE FRAME	EA			4	*	*	*	*	*	8	4	
0182		H		5305-017-9889	SCREW, CAP, HEXAGON HEAD: UPPER TRUSS TO SOLID FRAME	EA			4	*	*	*	*	*			
0183		H		5305-043-1933	SCREW, CAP, SOCKET HEAD: BEARER TO CYLINDER	EA			2	*	*	*	*	*	11	7	

LINE NO	(1) SOURCE, MAINT. AND RECOV. CODE			(2) FEDERAL STOCK NUMBER	(3) DESCRIPTION	(4) UNIT OF ISSUE	(5) QTY INC IN UNIT PACK	(6) QTY INC IN UNIT	(7) 15 DAY ORG. MAINT. ALW.			(8) 1-YR ALW PER100 EQUIP CTYGCY PLANNING	(9) DEPOT MAINT. ALW. PER 100 EQUIP	(10) ILLUSTRATION			
	(a) S	(b) M	(c) R						MANUFACTURER'S		(a) 1-20			(b) 21-50	(c) 51-100	(a) FIG. NO.	(b) ITEM OR SYM. NO.
									CODE	PART NUMBER							
0184		F		5305-013-8247	SCREW, CAP, SOCKET HEAD: CLAMP BEARING MOUNTING	EA		6	*	*	*	*	*	3	11		
0185		H		5305-276-8358	SCREW, CAP, SOCKET HEAD: GEAR RACK-TO SIDE FRAME MTG	EA		20	*	*	*	*	*	2	4		
0186		0		5305-013-8252	SCREW, CAP, SOCKET HEAD: HANDWHEEL TO PINION DRIVE GEAR MTG	EA		3	*	*	*	*	*	1	8		
0187		F		5305-273-6511	SCREW, CAP, SOCKET HEAD: LATCH BLOCK MOUNTING	EA		2	*	*	*	*	*	8	9		
0188	X2	F			SCREW, CONTINUOUS THREAD: GUIDE INDEX, 1/2-18 THD SIZE, 2 3/4 in. LG	EA	52565	0P235	4	*	*	*	*	*	5	4	
0189		0		5305-275-9840	SCREW, MACHINE: BAR CLAMP TO CYLINDER BLANKET MTG	EA		16	*	*	*	*	*	12	3		
0190		F		5305-011-3914	SCREW, MACHINE: BRACKET GRIPPER SHAFT	EA		2	*	*	*	*	*				
0191		F		5305-011-4406	SCREW, MACHINE: CLAMPING BAR TO SHAFT BRACKET AND ADJUSTING BRACKET	EA		12	*	*	*	*	*	3	13		
0192		0		5305-011-0499	SCREW, MACHINE: DRIVE SHAFT GUARD MTG	EA		2	*	*	*	*	*	7	1		
0193		F		5305-011-3914	SCREW, MACHINE: GRIPPER SHAFT BEARING MOUNTING	EA		4	*	*	*	*	*	4	3		
0194		0		5305-685-1344	SCREW, MACHINE: GUIDE ARM SHAFT	EA		2	*	*	*	*	*	5	7		
0195		0		5305-011-4703	SCREW, MACHINE: PINION DRIVING GEAR TO PULLEY	EA		3	*	*	*	*	*	7	11		
0196		0		5305-012-0628	SCREW, MACHINE: PULLEY UARD MTG	EA		5	*	*	*	*	*				
0197		F		5305-269-6646	SETSCREW: BED ADJUSTING SCREW GUIDE	EA		8	*	*	*	*	*	3	15		
0198		0		5305-010-2594	SETSCREW: GRIPPER	EA		6	*	*	*	*	*	4	11		
0199		H		5305-010-2592	SETSCREW: PINION GEAR	EA		2	*	*	*	*	*	7	6		
0200		0		5305-010-2595	SETSCREW: TREADLE LEVER	EA		1	*	*	*	*	*	6	7		
0201	X2	F			SHAFT: BED PLATE CLAMP	EA	52565	0P291	1	*	*	*	*	3	12		
0202	X2	F			SHAFT: CYLINDER LIFT LEVER	EA	52565	0P251	1	*	*	*	*	9	13		
0203	X2	0			SHAFT: GUIDE ARM	EA	52565	0P250	1	*	*	*	*	5	6		
0204	X2	0			SHAFT: TREADLE, FOOT	EA	52565	0P248	1	*	*	*	*	6	6		
0205	X2	H			SHAFT, DRIVE: CARRIAGE	EA	52565	0P256	1	*	*	*	*	7	5		
0206	X2	F			SHAFT, GRIPPER	EA	52565	0P249	1	*	*	*	*	4	4		
0207	X2	0			SPACER: HAND WHEEL	EA	52565	0P1026	1	*	*	*	*				
0208	P	F		5300-597-3822	SPRING, HELICAL, COMPRESSION: LATCH BLOCK	EA	52565	IRDPX206	1	2	2	3	30	5			
0209	P	F		3610-597-3923	SPRING, HELICAL, COMPRESSION: STOP BLOCK	EA	52565	0P288	8	2	4	8	96	45	2	12	
0210	X2	0		3610-531-7277	SPRING, HELICAL, EXTENSION: GRIPPER TO THEADLE SHAFT LEVER	EA	52565	THX129	1	*	*	*	*	*	6	3	
0211	X2	F			STOP, BLOCK: SIDE FRAME, LH	EA	52565	0P285L	2	*	*	*	*	*	2	11	
0212	X2	F			STOP, BLOCK: SIDE FRAME, RH	EA	52565	0P285R	2	*	*	*	*	*			
0213	X2	F			STOP, CARRIAGE: SIDE FRAME	EA	52565	0P287	4	*	*	*	*	*	2	13	
0214	X2	F			STOP, LIFT LEVER	EA	52565	0P297	1	*	*	*	*	*	9	11	
0215	X2	0		5307-353-5630	STUD, GUIDE ADJUSTING	EA	52565	0P276	1	*	*	*	*	*	5	3	
0216	X2	0			STUD, PLAIN: HANDWNEEL	EA	52565	0P290	2	*	*	*	*	*	3	9	

LINE NO	(1) SOURCE, MAINT. AND RECOV. CODE			(2) FEDERAL STOCK NUMBER	(3) DESCRIPTION	(4) UNIT OF ISSUE	(5) QTY INC IN UNIT PACK	(6) QTY INC IN UNIT	(7) 15 DAY ORG. MAINT. ALW.			(8) 1-YR ALW PER100 EQUIP CTYGCY PLANNING	(9) DEPOT MAINT. ALW. PER 100 EQUIP	(10) ILLUSTRATION			
	(a) S	(b) M	(c) R						MANUFACTURER'S		(a) 1-20			(b) 21-50	(c) 51-100	(a) FIG. NO.	(b) ITEM OR SYM. NO.
									CODE	PART NUMBER							
0217	X2	F			STUD, PLAIN: STOP BLOCK			12	*	*	*	*	*	2	9		
0218	X2	F			SUPPORT, CLAMPING BAR	52565	0P289	3	*	*	*	*	*	3	7		
0219	X2	0			SUPPORT, INDEX GUIDE	52565	0P229	1	*	*	*	*	*	5	2		
0220		0		5305-639-8108	THUMBSCREW: INDEX GUIDE SUPPORT			1	*	*	*	*	*	5	8		
0221	X2	0			TREADLE, GRIPPER: LH	52565	0P232L	1	*	*	*	*	*	6	8		
0222	X2	0			TREADLE, GRIPPER: RH	52565	0P232R	1	*	*	*	*	*	6	4		
0223	X2	H			TRUSS, FRAME: LOWER, TO SIDE FRAMES	52565	0P243	1	*	*	*	*	*	2	17		
0224	X2	H			TRUSS, FRAME: UPPER, TO SIDE FRAMES	52565	0P244	1	*	*	*	*	*	2	16		
0225	M	0			TUBE, COPPER: OIL ECCENTRIC BEARING	52565	0P1062	2									
					MANUFACTURE FROM:												
0225A	P	0		4710-277-5526	TUBE, COPPER				SEE	GRP	9501						
					10 in. REQUIRED FOR EACH)												
0226	M	0			TUBE, COPPER: OIL, FRONT CARRIAGE RH, LH WHEEL BEARING	52565	0P1063	2									
					MANUFACTURE FROM:												
0226A	P	0		4710-277-5526	TUBE, COPPER				SEE	GRP	9501						
					(26 in. REQUIRED FOR EACH)												
0227	M	0			TUBE, COPPER: OIL, REAR CARRIAGE RH AND LH WHEEL BEARING	52565	0P1064	2									
					MANUFACTURE FROM:												
0227A	P	0		4710-277-5526	TUBE, COPPER				SEE	GRP	9501						
					(34 in. REQUIRED FOR EACH)												
0228	M	0			TUBE, COPPER: OIL, PINION STUD	52565	0P1065	2						9	2		
					MANUFACTURE FROM:												
0228A	P	0		4710-277-5526	TUBE, COPPER				SEE	GRP	9501						
					(20 in. REQUIRED FOR EACH)												
0229		0		5310-010-0308	WASHER, FLAT: PINION DRIVING GEAR TO PULLEY			3	*	*	*	*	*	7	10		
0230		H		5310-010-3325	WASHER, LOCK			3	*	*	*	*	*	10	6		
0231		H		5310-010-3325	WASHER, LOCK: SPUR PEAR AND CYLINDER BEARING LH MTG			3	*	*	*	*	*				
0232	X2	F			WASHER: PINION STUD	52565	0P1025	1	*	*	*	*	*	7	13		
0233	X2	F			WEIGHT, BALANCE: CYLINDER	52565	0P2001	1	*	*	*	*	*				
0234	X2	F			WHEEL, CARRIAGE	52565	0P224	4	*	*	*	*	*				
0235					GROUP 95 - GENERAL USE STANDARDIZED PARTS												
0236					9501 - BULK MATERIAL												
0237	P	F		3610-979-7455	CABLE, POWER, ELECTRICAL: COPPER, No. 14 AWG, 2 CONDUCTORS, SOLID				2	3	6	75	15	15			
0238	P	F		3610-979-7455	CABLE, SPECIAL PURPOSE, ELECTRICAL				2	3	6	75	15				
0239	P	F		9510-229-4849	STEEL BAR, CARBON, COLD FINISHED: 5/16 in. SQUARE				*	*	2	10	2				

LINE NO	(1) SOURCE, MAINT. AND RECOV. CODE			(2) FEDERAL STOCK NUMBER	(3) DESCRIPTION	(4) UNIT OF ISSUE	(5) QTY INC IN UNIT PACK	(6) QTY INC IN UNIT	(7) 15 DAY ORG. MAINT. ALW.			(8) 1-YR ALW PER100 EQUIP CTYGCY PLANNING	(9) DEPOT MAINT. ALW. PER 100 EQUIP	(10) ILLUSTRATION			
	(a) S	(b) M	(c) R						MANUFACTURER'S		(a) 1-20			(b) 21-50	(c) 51-100	(a) FIG. NO.	(b) ITEM OR SYM. NO.
									CODE	PART NUMBER							
0240	P	0		4710-277-5526	TUBE, COPPER: 0.313 in. DIA	FT			2	2	3	40	8				
0241	P	F		6145-164-6756	WIRE, ELECTRICAL: COPPER, CONDUCTOR, No. 14 AWG STRANDED, 41 STRANDS No. 30 AWG	FT			8	16	31	375	75				
0242					SECTION 6 - SPECIAL TOOLS, TEST AND SUPPORT EQUIPMENT, DS, GS, AND DEPOT LEVEL												
0242A					GROUP 26 - TOOLS AND TEST EQUIPMENT												
0243					2604 - SPECIAL TOOLS												
0243A					NOTE: IF THESE TOOLS ARE NOT A COMPONENT OF AUTHORIZED TA OR TOE TOOLSETS, A QUANTITY NECESSARY FOR THE PERFORMANCE OR ASSIGNED MAINTENANCE MISSION IS AUTHORIZED FOR EACH DS, GS, AND DEPOT MAINTENANCE FACILITY												
0244	X2	0			CRANK: CARRIAGE 52565 0P221	EA		1	*	*	*	*	*				
0245	X1				GRIP: CARRIAGE CRANK 52565 0P265	EA		1									
0246	X1				STUD, CRANK 52565 THX107	EA		1									
0247	X1				WASHER, CRANK 52565 0P264	EA		1									
0248	X2	0			EDGE, STRAIGHT 52565 0P281-1	EA		1	*	*	*	*	*				
0249	P	0	5210-277-8840		INDICATOR, DIAL: TEST 08288 MSS5210-3	EA		1	*	*	*	7	2				
0250	X2	0	5120-240-7308		BLOCK, BENCH 08288 MSS5120-1	EA		1	*	*	*	*	*				
0251	X2	0			NUT: BENCH BLOCK 52565 0P1069	EA		1	*	*	*	*	*				
0252	X2	0			PIN, STRAIGHT, HEADLESS: 3/8 in. DIA, 9 in. LG 52565 0P1001	EA		1	*	*	*	*	*				
0253	X2	0			SLEEVE: 3/8 HOLE 52565 0P1003	EA		1	*	*	*	*	*				
0254	X2	0			STUD, INDICATOR 52565 0P1000	EA		1	*	*	*	*	*				
0255		0	5310-012-0393		WASHER, FLAT	EA		1	*	*	*	*	*				
0256	X2	0			WRENCH: REEL ROD 52565 0P272	EA		1	*	*	*	*	*				
0257	X2	0			WRENCH: WHEEL 52565 0P279	EA		1	*	*	*	*	*				

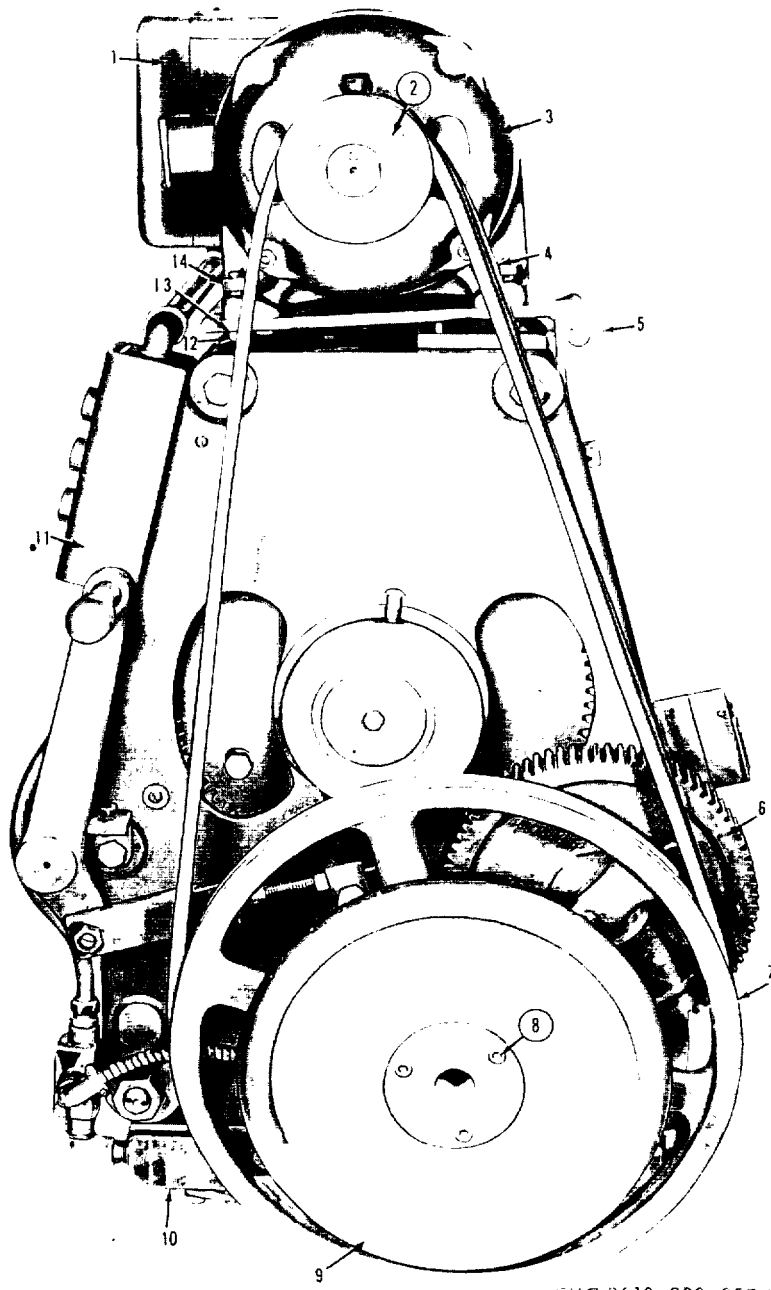

EMC 3610-200-25P/1

Figure 1. Drive End Cylinder Carriage Assembly.

INDEX TO PARTS, FIGURE 1

REF NO.	FUNCT GROUP	ITEM NAME	REF NO.	FUNCT GROUP	ITEM NAME
1	4010	STARTER	8	6503	SCREW
2	4007	PULLEY	9	6503	HANOWHEEL
3	4000	MOTOR	10	4011	SWITCH
4	4007	BELT	11	5010	SWITCH
5	4000	HINGE	12	4000	SCREW
6	6503	GEAR	13	4000	PLATE
7	6503	PULLEY	14	4000	NUT

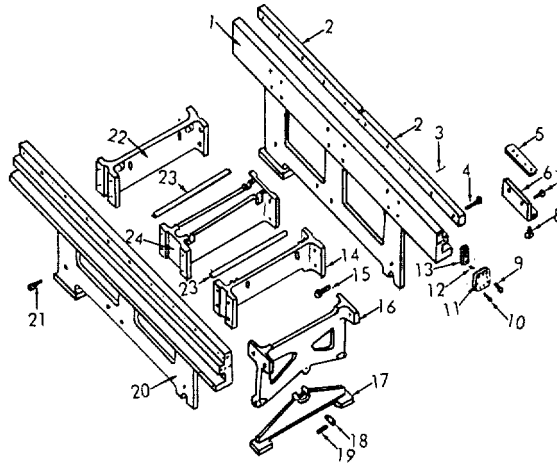

EMC 3610-200-25P/2

Figure2. Frames and Supports.
INDEX TO PARTS, FIGURE 2

REF NO.	FUNCT GROUP	ITEM NAME	REF NO.	FUNCT GROUP	ITEM NAME	REF NO.	FUNCT GROUP	ITEM NAME
1	6503	FRAME	9	6503	STUD	17	6503	TRUSS
2	6503	GEAR	10	6503	SCREW	18	6503	PIN
3	6503	PIN	11	6503	STOP	19	6503	PIN
4	5503	SCREW	12	6503	SPRING	20	6503	FRAME
5	4011	BREAKER	13	6503	STOP	21	6503	SCREW
6	4011	SUPPORT	14	6503	BRACE	22	6503	BRACE
7	4011	SCREW	15	6503	SCREW	23	6503	BAR
8	4011	SCREW	16	6503	TRUSS	24	6503	BRACE

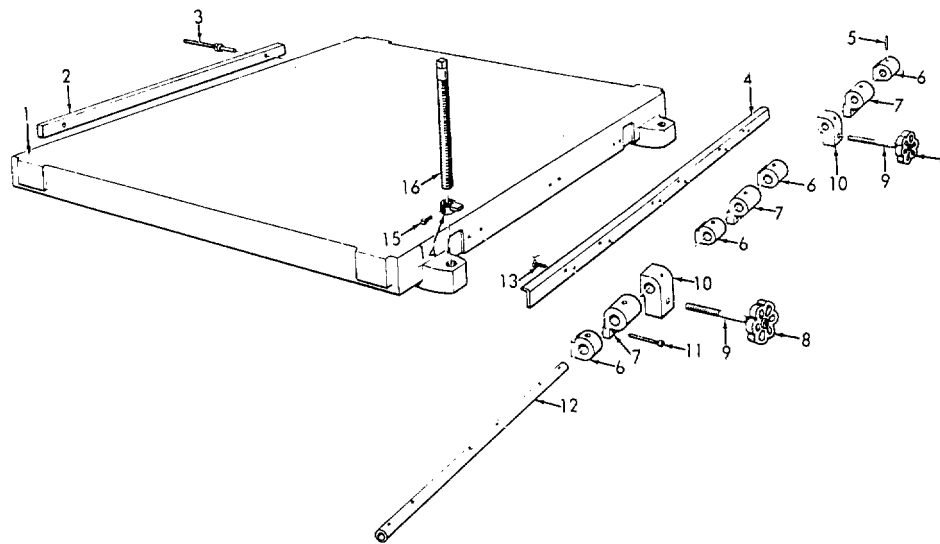

EMC 3610-200-25P/3

Figure 3. Plate Bed.
INDEX TO PARTS, FIGURE 3

REF NO.	FUNCT GROUP	ITEM NAME	REF NO.	FUNCT GROUP	ITEM NAME	REF NO.	FUNCT GROUP	ITEM NAME
1	6503	PLATE	7	6503	SUPPORT	12	6503	SHAFT
2	6503	GIB	8	6503	HANDWHEEL	13	6503	SCREW
3	6503	BOLT	9	6503	STUD	14	6503	GUIDE
4	6503	BAR	10	6503	CLAMP	15	6503	SETSCREW
5	6503	PIN	11	6503	SCREW	16	6503	SCREW
6	6503	BRACKET						

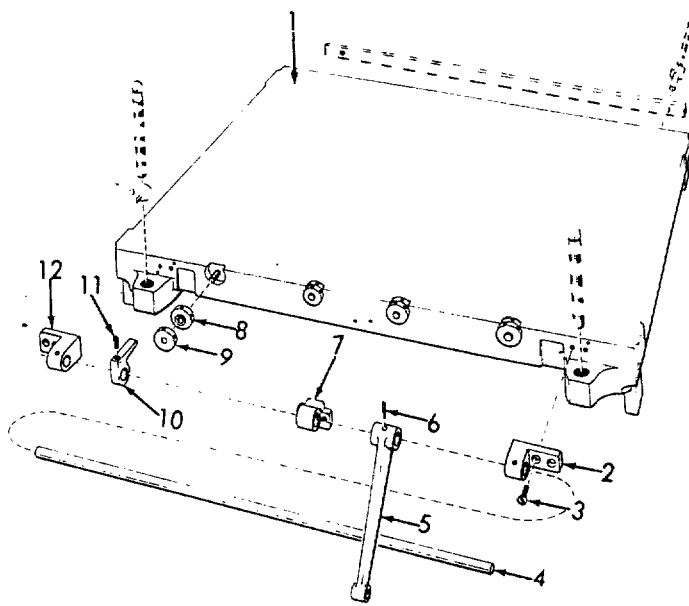

EMC 3610-200-25 P/4

Figure 4. Printing Bed.

INDEX TO PARTS, FIGURE 4

REF NO.	FUNCT GROUP	ITEM NAME	REF NO.	FUNCT GROUP	ITEM NAME
1	6503	BED	7	6503	BRACKET
2	6503	BRACKET	8	6503	NUT
3	6503	SCREW	9	6503	NUT
4	6503	SHAFT	10	6503	GRIPPER
5	6503	LEVER	11	6503	SETSCREW
6	6503	PIN	12	6503	BRACKET

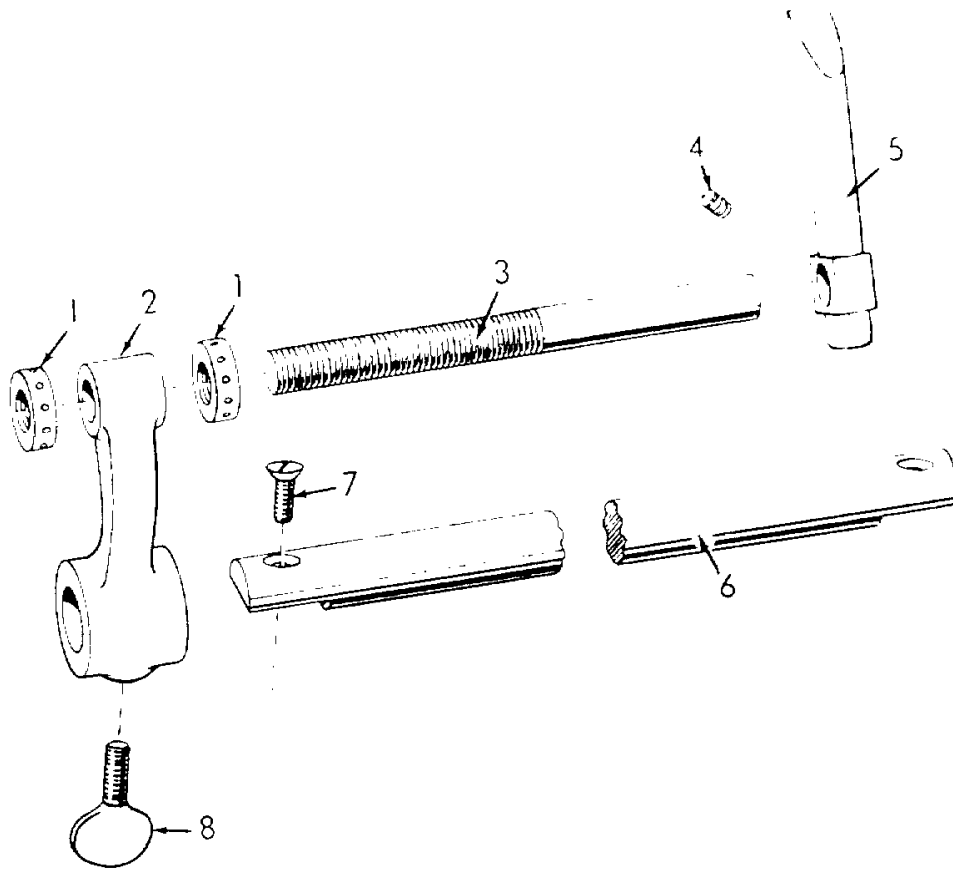

EMC 3610-200-25F 5

Figure 5. Printing Bed Guide Index.

INDEX TO PARTS, FIGURE 5

REF NO.	FUNCT GROUP	ITEM NAME	REF NO.	FUNCT GROUP	ITEM NAME
1	6503	NUT	5	6503	GUIDE
2	6503	SUPPORT	6	6503	SHAFT
3	6503	STUD	7	6503	SCREW
4	6503	SCREW	8	6503	THUMBSCREW

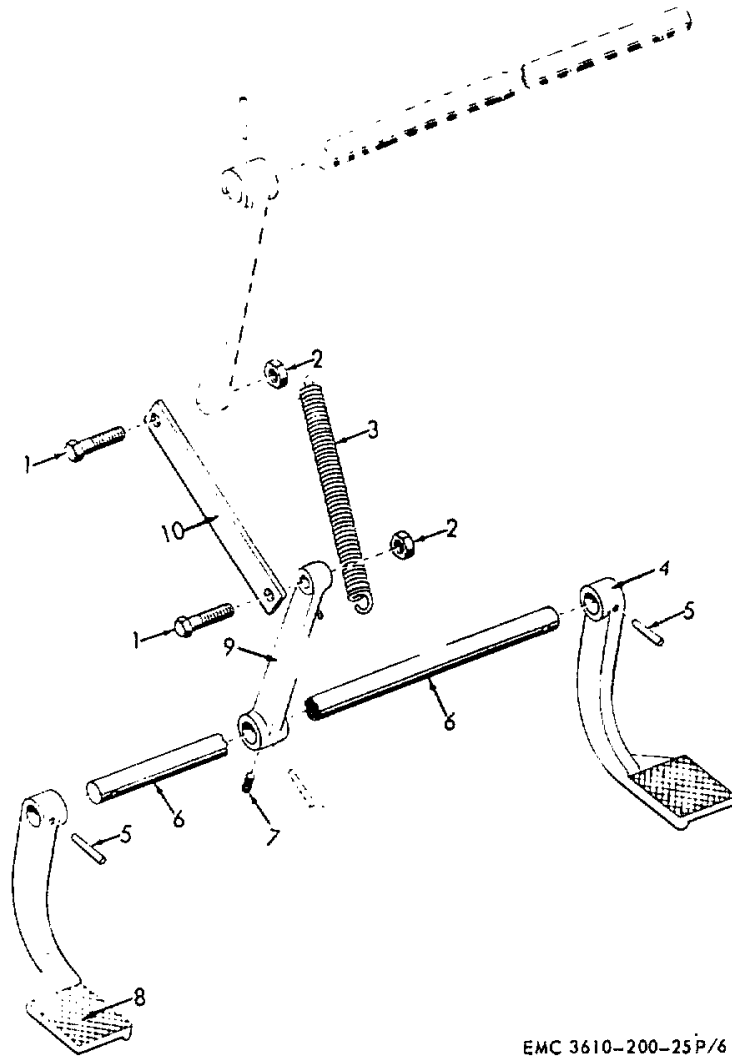

EMC 3610-200-25 P/6

Figure 6. Gripper Control Linkage.

INDEX TO PARTS, FIGURE 6

REF NO.	FUNCT GROUP	ITEM NAME	REF NO.	FUNCT GROUP	ITEM NAME
1	6503	SCREW	6	6503	SHAFT
2	6503	NUT	7	6503	SETSCREW
3	6503	SPRING	8	6503	TREADLE
4	6503	TREADLE	9	6503	LEVER
5	6503	PIN	10	6503	LINK

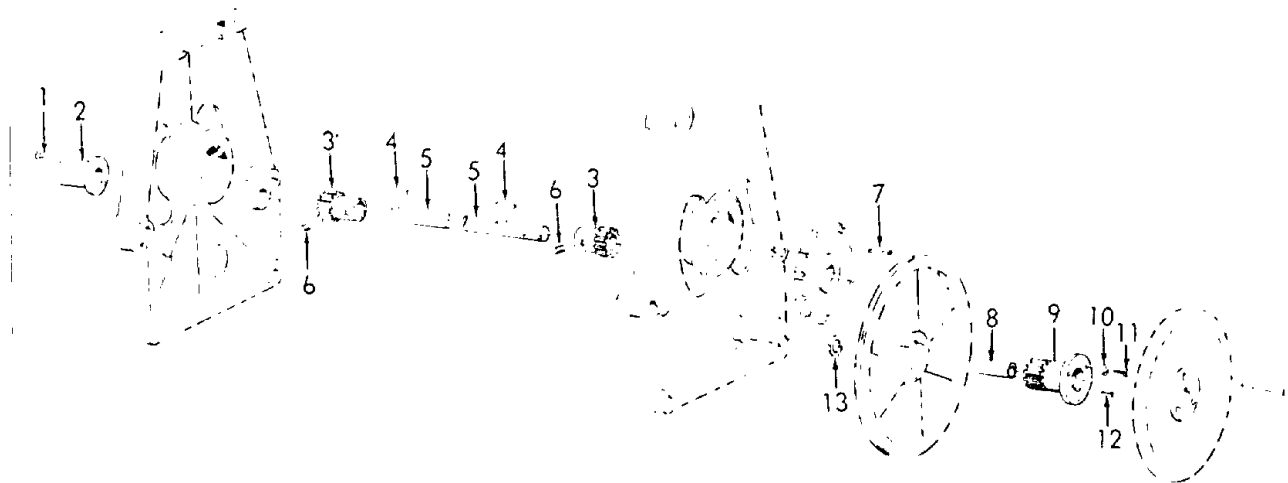

EMC 3610-200-25P/7

Figure 7. Carriage Drive.

INDEX TO PARTS, FIGURE 7

REF NO.	FUNCT GROUP	ITEM NAME	REF NO.	FUNCT GROUP	ITEM NAME
1	6503	SCREW	8	6503	BEARING
2	6503	GUARD	9	6503	GEAR
3	6503	GEAR	10	6503	WASHER
4	6503	KEY	11	6503	SCREW
5	6503	SHAFT	12	6503	KEY
6	6503	SETSCREW	13	6503	WASHER
7	6503	KEY			

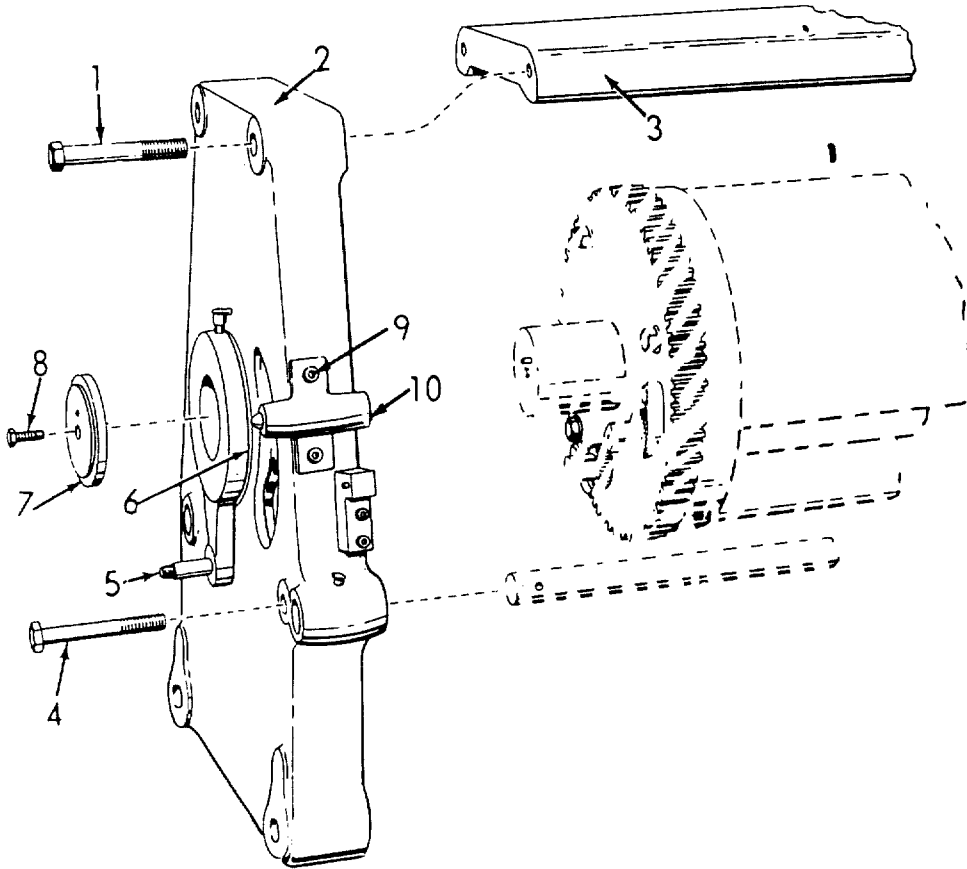

EMC 3610-200-25 P/8

Figure 8. Right End Carriage Frame.

INDEX TO PARTS, FIGURE 8

REF NO.	FUNCT GROUP	ITEM NAME	REF NO.	FUNCT GROUP	ITEM NAME
1	6503	SCREW	6	6503	ECCENTRIC
2	6503	FRAME	7	6503	CAP
3	6503	BRACE	8	6503	SCREW
4	6503	SCREW	9	6503	SCREW
5	6503	BOLT	10	6503	PLUNGER

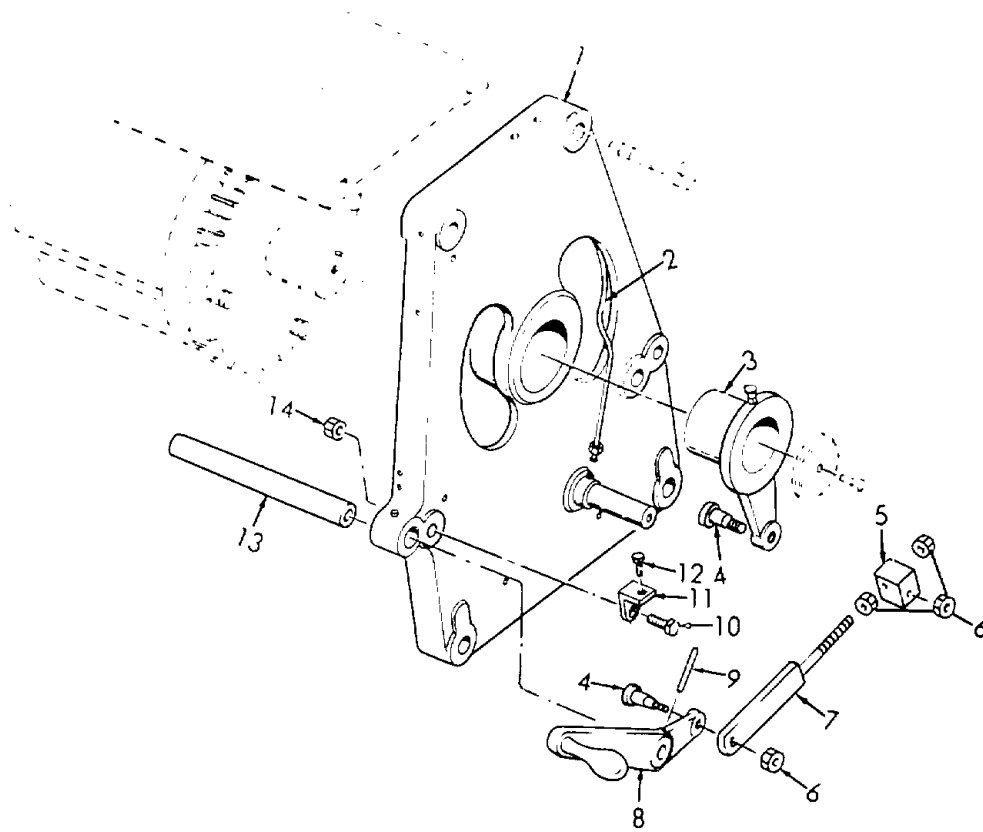

EMC 3610-200-25 P/9

Figure 9. Left End Carriage Frame.

INDEX TO PARTS, FIGURE 9

REF NO.	FUNCT GROUP	ITEM NAME	REF NO.	FUNCT GROUP	ITEM NAME
1	6503	FRAME	8	6503	LEVER
2	6503	TUBE	9	6503	PIN
3	6503	ECCENTRIC	10	6503	SCREW
4	6503	BOLT	11	6503	STOP
5	6503	BLOCK	12	6503	SCREW
6	6503	NUT	13	6503	SHAFT
7	6503	LINK	14	6503	NUT

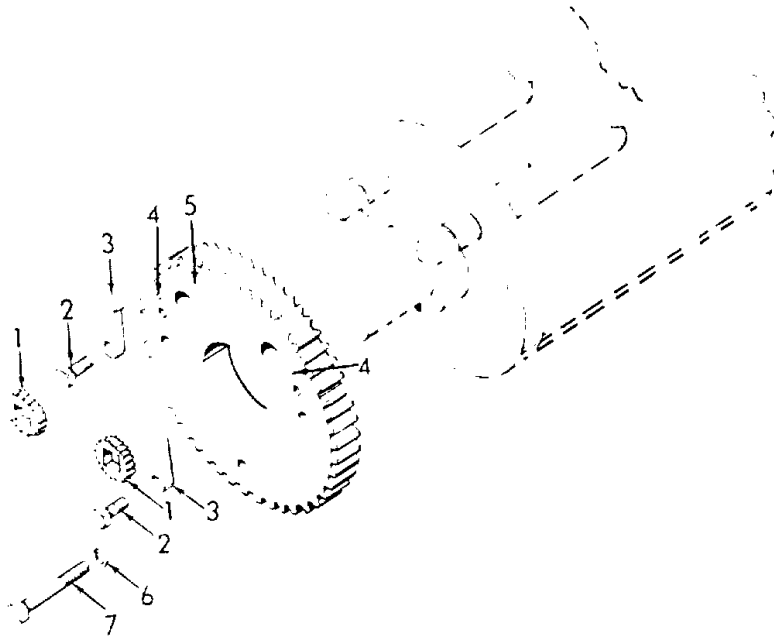

EMC 3610-200-25P 10

Figure 10. Cylinder Spur Gear Blanket Adjustment End.

INDEX TO PARTS, FIGURE 10

REF NO.	FUNCT GROUP	ITEM NAME
1	6503	RATCHET
2	6503	SCREW
3	6503	PAWS
4	6503	PIN
5	6503	GEAR
6	6503	WASHER
7	6503	SCREW

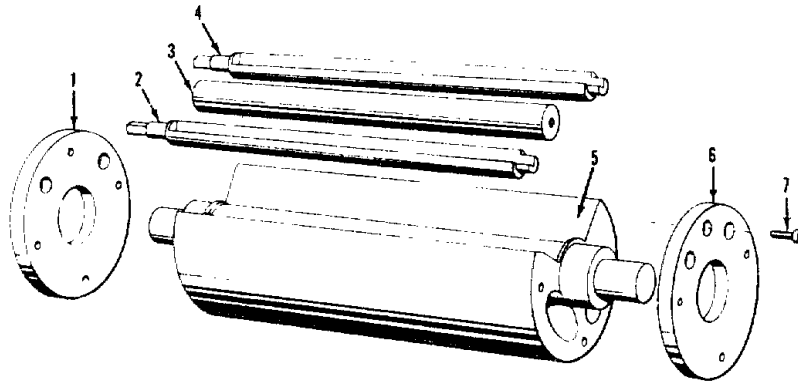

EMC 3610-200-25 P/11

Figure 11. Cylinder.

INDEX TO PARTS, FIGURE 11

REF NO.	FUNCT GROUP	ITEM NAME
1	6503	BEARER
2	6503	ROD
3	6503	ROD
4	6503	ROD
5	6503	CYLINDER
6	6503	BEARER
7	6503	SCREW

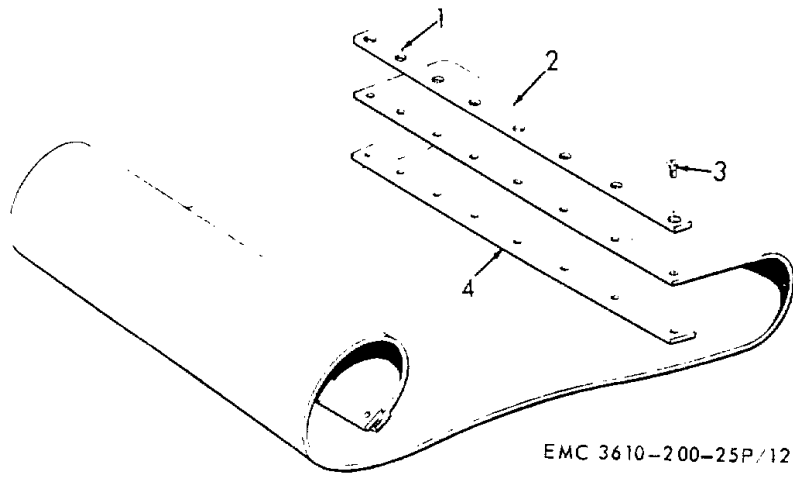

Figure 12. Blanket and Bars.

INDEX TO PARTS, FIGURE 12

REF NO.	FUNCT GROUP	ITEM NAME
1	6503	BAR
2	6503	BLANKET
3	6503	SCREW
4	6503	BAR

SECTION 7.

FEDERAL STOCK NUMBER AND PART NUMBER INDEX

NUMBER	CODE	PAGE	NUMBER	CODE	PAGE	NUMBER	CODE	PAGE
CR2940AA1038	24446	006	0P1088	52565	007			011
CR9440LS4150	24446	006	0P1089	52565	007	0P251	52565	011
CR9440LS415E	24446	006	0P1090	52565	007	0P256	52565	011
LRDPX206	52565	011	0P1091	52565	007	0P258	52565	006
1R0PX433	52565	009	0P1092	52565	007	0P259L	52565	006
MSS3030-6	08288	001	0P1093	52565	007	0P260	52565	006
		006	0P1094	52565	007	0P262	52565	008
MSS5120-1	08288	004	0P1147	52565	002	0P263	52565	008
		013			008	0P264	52565	004
MSS5210-3	08288	004	0P1149	52565	002			013
		013			008	0P265	52565	004
MS55305-7	08288	006	0P1150	52565	002			013
0P259R	52565	006			008	0P267	52565	002
PLBE564	52565	001	0P1153	52565	002			008
		005			009	0P268	52565	010
RL8450	52565	002	0P1179	52565	002	0P269	52565	008
		008			009	0P271	52565	008
SDP3	52565	009	0P1180	52565	002	0P272	52565	004
THX016	52565	008			009			013
THX107	52565	004	0P2001	52565	012	0P273	52565	008
		013	0P201LH	52565	008	0P274	52565	008
THX129	52565	003	0P201RH	52565	008	0P275	52565	002
		011	0P202	52565	009			009
THX131	52565	002	0P203	52565	008	0P276	52565	003
		009	0P204	52565	008			011
THX132	52565	002	0P205	52565	008	0P277	52565	002
		009	0P206	52565	008			009
OPE503	52565	001	0P207	52565	008	0P278	52565	009
		005	0P208	52565	008	0P279	52565	004
0P1000	52565	004	0P209	52565	008			013
		013	0P211	52565	008	0P280	52565	009
0P1001	52565	004	0P213L	52565	008	0P281-1	52565	004
		013	0P213R	52565	008			013
0P1003	52565	004	0P214	52565	009	0P282	52565	008
		013	0P215	52565	009	0P285L	52565	011
0P1006	52565	006	0P218	52565	002	0P285R	52565	011
0P1010-1	52565	002			009	0P286	52565	010
		008	0P219	52565	002	0P287	52565	011
0P1011-1	52565	009			009	0P288	52565	011
P01012-1	52565	008	0P22L	52565	008	0P289	52565	012
0P1024	52565	002	0P220L	52565	002	0P290	52565	003
		009			009			011
0P1025	52565	012	0P220R	52565	002	0P291	52565	011
0P1026	52565	003			009	0P292	52565	002
		0011	0P221	52565	004			008
0P1027	52565	002			013	0P293	52565	002
		010	0P222R	52565	008			008
0P1029	52565	005	0P223	52565	012	0P294	52565	009
0P1030	52565	005	0P224	52565	012	0P295	52565	010
0P1034	52565	005	0P2251	52565	009	0P296	52565	008
0P1035	52565	001	0P225R	52565	009	0P297	52565	011
		006	0P226	52565	008	0P299	52565	008
0P1036	52565	005	0P227	52565	008	1219	24981	000
0P1045	52565	006	0P228	52565	008			008
0P1049	52565	001	0P229	52565	003	132377	24446	001
		006			012			005
0P1052	52565	001	0P230	52565	008	160-2-2	41311	006
		005	0P231	52565	008	160-31-5-0	41311	006
0P1062	52565	003	0P232L	52565	003	2236024G5	24446	006
		012			012			006
0P1063	52565	003	0P232R	52565	003	24V28-1900	41311	006
		012			012	2610-979-7455		007
0P1064	52565	003	0P233	52565	010			012
		012	0P234	52565	010			012
0P1065	52565	003	0P235	52565	011	3030-233-6924		001
		012	0P236	52565	002			006
0P1069	52565	004			009	3110-271-0212		008
		013	0P239	52565	010	340012	79470	002
0P1070	52565	001	0P240	52565	009			008
		005	0P241	52565	002	3610-288-2208		008
0P1076	52565	007			009	3610-346-3000		002
0P1077	52565	007	0P242	52565	008			009
0P1078	52565	007	0P243	52565	012	3610-353-5627		002
0P1079	52565	007	0P244	52565	012			008
0P1080	52565	007	0P246	52565	008	3610-353-5631		010
0P1081	52565	007	0P247	52565	002	3610-353-5633		002
051082	52565	007			009			008
0P1083	52565	007			010	3610-371-4556		008
0P1084	81336	007	0P248	52565	003	3610-371-4557		008
0P1085	52565	007			011	3610-374-2975		008
0P1086	52565	007	0P249	52565	011	3610-374-2976		008
0P1087	52565	007	0P250	52565	003	3610-374-2977		009

FEDRAL STOCK NUMBER AND PART NUMBER INDEX

NUMBER	CODE	PAGE	NUMBER	CODE	PAGE	NUMBER	CODE	FPAGE
3610-374-2978		009	5305-978-9394		005			
3610-377-4955		009	5306-274-3174		008			
3610-531-7277		003	5306-274-3175		002			
		011			008			
3610-597-3923		011	5306-346-0023		008			
3610-884-4748		006	5306-353-5623		006			
3610-884-4749		006	5306-374-2973		009			
3610-979-7454		007	5307-353-5630		003			
3610-997-6010		010			011			
41799	24446	001	5310-010-0308		003			
		005			012			
4710-277-5526		003	5310-010-2637		002			
		003			002			
		003			009			
		003			009			
		003			009			
		012	5310-010-3323		001			
		012			006			
		012	5310-010-3325		012			
		012			012			
		013	5310-012-0393		004			
4730-174-4518		002			013			
		008	5310-022-0081		009			
4730-202-8003		001	5310-022-0083		009			
		007	5310-274-7874		002			
4730-277-8265		002			009			
		008	5310-274-7879		002			
4730-276-9438		002			009			
		008	5310-389-6462		002			
4730-595-2634		001			009			
		007	5310-655-9544		009			
5120-240-7308		004	5310-685-1429		001			
		013			005			
5210-277-8840		004	5315-010-3692		009			
		013	5315-013-7204		009			
5305-010-2592		011	5315-198-5974		002			
5305-010-2594		003			010			
		011	5315-198-5975		009			
5305-010-2595		003	5315-198-5976		010			
		011	5315-198-5982		002			
5305-011-0499		002			010			
		011	5315-198-5988		002			
5305-011-3914		011			010			
		011	5315-198-5991		010			
5305-011-4406		011	5315-246-9722		009			
5305-011-4703		002	5315-271-75b6		009			
		011	5340-254-2890		007			
5305-012-0628		003	5340-353-5622		002			
		011			008			
5305-013-8247		011	5340-597-3822		011			
5305-013-8252		002	5930-024-2161		006			
		011	5930-112-5272		006			
5305-017-9837		010	5930-262-9957		006			
5305-017-9841		010	5930-328-5558		006			
5305-017-9885		002	5930-371-4562		006			
		010	5945-241-7738		006			
		010	5945-395-2509		006			
5305-017-9887		001	5970-884-4783		007			
		005	5975-050-6822		007			
5305-017-9889		010	5975-152-1072		007			
5305-017-9933		010	5975-280-3194		007			
5305-021-6059		010	5975-893-8544		007			
		010	6145-164-6756		007			
		010			013			
5305-021-6061		010	61915	38740	001			
5305-021-7910		006			005			
5305-043-1933		010	68X5	79470	001			
5305-269-6646		011			007			
5305-273-5249		006	7-48-1	41311	006			
5305-273-6511		011	7-49-1	41311	006			
5305-275-9840		002	7-50-1	41311	006			
		011	7005KV66	41311	006			
5305-276-8358		011	7612D2-3PDT	15605	006			
5305-353-5628		010	9510-229-4849		009			
5305-543-4527		006			012			
5305-577-5462		010	9905-803-9431		005			
		010						
5305-591-9313		010						
5305-639-8108		003						
		012						
5305-685-1344		002						
		011						

By Order of the Secretary of the Army:

HAROLD K. JOHNSON,
General, United States Army,
Chief of Staff.

Official:

KENNETH G. WICKHAM,
Major General, United States Army,
The Adjutant General.

Distribution:

Active Army:

USASA (2)
 ACSI (1)
 DCSLOG (1)
 CNGB (1)
 TSG (1)
 CofEngrs (3)
 CC-E (1)
 Dir of Trans (1)
 CofSptS (1)
 USAMB (1)
 USAARTYBD (2)
 USAARENBD (2)
 USAIB (2)
 USAADBBD (2)
 USAAESWBD (2)
 USAAVNTBD (2)
 USCONARC (3)
 OS Maj Comd (5)
 USAMC (1)
 MDW (1)
 Armies (2)
 Corps (2)
 USAC (1)
 Div (2)
 Engr Bde (1)
 USMA (2)
 Svc Colleges (2)
 Br Svc Sch (2)

Gen Dep (10)
 Engr Dep (10)
 Army Dep (2) except
 TOAD (3)
 USA Tml Comd (2)
 Army Tml (1)
 Div Engr (2)
 Engr Dist (2)
 USA Engr RD lab (3)
 USAMEC (46)
 USACDCEC (10)
 USAECFB (5)
 USAREUR Engr Proc Cen (2)
 USAREUR Engr Sup Con Agcy (10)
 Engr FLDMS (2)
 Ft Knox FLDMS (10)
 Fld Cormd, DASA (8)
 AMS (3)
 USAREURCOMZ (2)
 MAAG (1)
 JBUSMC (1)
 Units org under fol TOE:
 5-48 (2)
 5-237 (5)
 5-262 (5)
 5-267 (1)
 5-278 (5)
 5-279 (2)

NG: None.

USAR: Same as Active Army except allowance is one copy to each unit.

For explanation of abbreviations used see AR 320-50.

RECOMMENDED CHANGES TO EQUIPMENT TECHNICAL PUBLICATIONS



THEN...JOT DOWN THE
DOPE ABOUT IT ON THIS FORM.
CAREFULLY TEAR IT OUT, FOLD IT
AND DROP IT IN THE MAIL.

SOMETHING WRONG WITH PUBLICATION

FROM: (PRINT YOUR UNIT'S COMPLETE ADDRESS)

DATE SENT

PUBLICATION NUMBER

PUBLICATION DATE

PUBLICATION TITLE

BE EXACT PIN-POINT WHERE IT IS

PAGE
NO.

PARA-
GRAPH

FIGURE
NO.

TABLE
NO.

IN THIS SPACE, TELL WHAT IS WRONG
AND WHAT SHOULD BE DONE ABOUT IT.

TEAR ALONG PERFORATED LINE

PRINTED NAME, GRADE OR TITLE AND TELEPHONE NUMBER

SIGN HERE

The Metric System and Equivalents

Linear Measure

1 centimeter = 10 millimeters = .39 inch
 1 decimeter = 10 centimeters = 3.94 inches
 1 meter = 10 decimeters = 39.37 inches
 1 dekameter = 10 meters = 32.8 feet
 1 hectometer = 10 dekameters = 328.08 feet
 1 kilometer = 10 hectometers = 3,280.8 feet

Weights

1 centigram = 10 milligrams = .15 grain
 1 decigram = 10 centigrams = 1.54 grains
 1 gram = 10 decigrams = .035 ounce
 1 dekagram = 10 grams = .35 ounce
 1 hectogram = 10 dekagrams = 3.52 ounces
 1 kilogram = 10 hectograms = 2.2 pounds
 1 quintal = 100 kilograms = 220.46 pounds
 1 metric ton = 10 quintals = 1.1 short tons

Liquid Measure

1 centiliter = 10 milliliters = .34 fl. ounce
 1 deciliter = 10 centiliters = 3.38 fl. ounces
 1 liter = 10 deciliters = 33.81 fl. ounces
 1 dekaliter = 10 liters = 2.64 gallons
 1 hectoliter = 10 dekaliters = 26.42 gallons
 1 kiloliter = 10 hectoliters = 264.18 gallons

Square Measure

1 sq. centimeter = 100 sq. millimeters = .155 sq. inch
 1 sq. decimeter = 100 sq. centimeters = 15.5 sq. inches
 1 sq. meter (centare) = 100 sq. decimeters = 10.76 sq. feet
 1 sq. dekameter (are) = 100 sq. meters = 1,076.4 sq. feet
 1 sq. hectometer (hectare) = 100 sq. dekameters = 2.47 acres
 1 sq. kilometer = 100 sq. hectometers = .386 sq. mile

Cubic Measure

1 cu. centimeter = 1000 cu. millimeters = .06 cu. inch
 1 cu. decimeter = 1000 cu. centimeters = 61.02 cu. inches
 1 cu. meter = 1000 cu. decimeters = 35.31 cu. feet

Approximate Conversion Factors

To change	To	Multiply by	To change	To	Multiply by
inches	centimeters	2.540	ounce-inches	newton-meters	.007062
feet	meters	.305	centimeters	inches	.394
yards	meters	.914	meters	feet	3.280
miles	kilometers	1.609	meters	yards	1.094
square inches	square centimeters	6.451	kilometers	miles	.621
square feet	square meters	.093	square centimeters	square inches	.155
square yards	square meters	.836	square meters	square feet	10.764
square miles	square kilometers	2.590	square meters	square yards	1.196
acres	square hectometers	.405	square kilometers	square miles	.386
cubic feet	cubic meters	.028	square hectometers	acres	2.471
cubic yards	cubic meters	.765	cubic meters	cubic feet	35.315
fluid ounces	milliliters	29.573	cubic meters	cubic yards	1.308
pints	liters	.473	milliliters	fluid ounces	.034
quarts	liters	.946	liters	pints	2.113
gallons	liters	3.785	liters	quarts	1.057
ounces	grams	28.349	liters	gallons	.264
pounds	kilograms	.454	grams	ounces	.035
short tons	metric tons	.907	kilograms	pounds	2.205
pound-feet	newton-meters	1.356	metric tons	short tons	1.102
pound-inches	newton-meters	.11296			

Temperature (Exact)

°F Fahrenheit temperature 5/9 (after subtracting 32) Celsius temperature °C

TM 5-3610-200-25P PRINTING PRESS; PROOF: OFFSET: FLOOR MOUNTING;-1967

PIN: 025521-000